

**HI**®

**MOTIONS**  
OPENING SOLUTIONS

**MADE IN ITALY**



CATALOGO | CATALOGUE

## STORIA HISTORY



B E N I N C À · H O L D I N G

**HI**  
MOTIONS  
OPENING SOLUTIONS

Il gruppo **BENINCA' HOLDING** in più di 30 anni ha fatto della specializzazione e della qualità il proprio punto di forza diventando in pochi anni uno dei principali player nel mercato internazionale dell'automazione.

**HI MOTIONS** è l'azienda del gruppo che porta con sé tutto il know how **BENINCÀ** con in più un forte orientamento al mercato e al cliente, principale interlocutore di tutte le scelte.

Opening solutions è il pay off che sintetizza la mission dell'azienda: offrire soluzioni per tutti i tipi di chiusure garantendo affidabilità, ma soprattutto flessibilità.

• • • • • • • •

In more than 30 years, the specialization and the quality have become the strong point of the **BENINCÀ HOLDING**: this group is now one of the biggest player in the international automation market.

**HI MOTIONS** is the company of the group with all the **BENINCÀ**'s know how with , in addition, a strong focus on the market and on the customer, which is the main figure in all its choices.

The company's pay off "opening solutions" says it all about its mission: offer solutions for all professional locking systems, with quality and, most of all, with flexibility.



### MADE IN ITALY

*HI MOTIONS da sempre considera la qualità e l'affidabilità del prodotto elementi essenziali per garantire il massimo servizio ai propri clienti. Per questo nel proprio processo produttivo ha fatto delle scelte precise in termini di qualità. Tutti i prodotti sono progettati e realizzati interamente in Italia, questo consente all'azienda di garantire al cliente un prodotto in grado di rispondere alle precise esigenze e richieste del mercato in termini di affidabilità e professionalità. Il made in Italy per HI MOTIONS dunque è non solo un elemento distintivo, ma una mission che perseguiamo ogni giorno anche attraverso il servizio offerto al cliente nella progettazione di servizi e sistemi personalizzati.*

*HI MOTIONS has always regarded product quality and reliability as essential elements in guaranteeing top-level service for its customers. For this reason, the company has implemented some specific adjustments to its production process in order to enhance quality. All the products are designed and manufactured entirely in Italy, therefore the company is able to guarantee customers a product capable of satisfying specific requirements and market requests in terms of reliability and professionalism. For HI MOTIONS, therefore, "made in Italy" quality is not only a distinctive element, but a mission we pursue day after day, also through the design of customised services and systems offered to customers.*



# CANCELLI SCORREVOLI SU ROTAIA

## SLIDING GATES ON TRACK

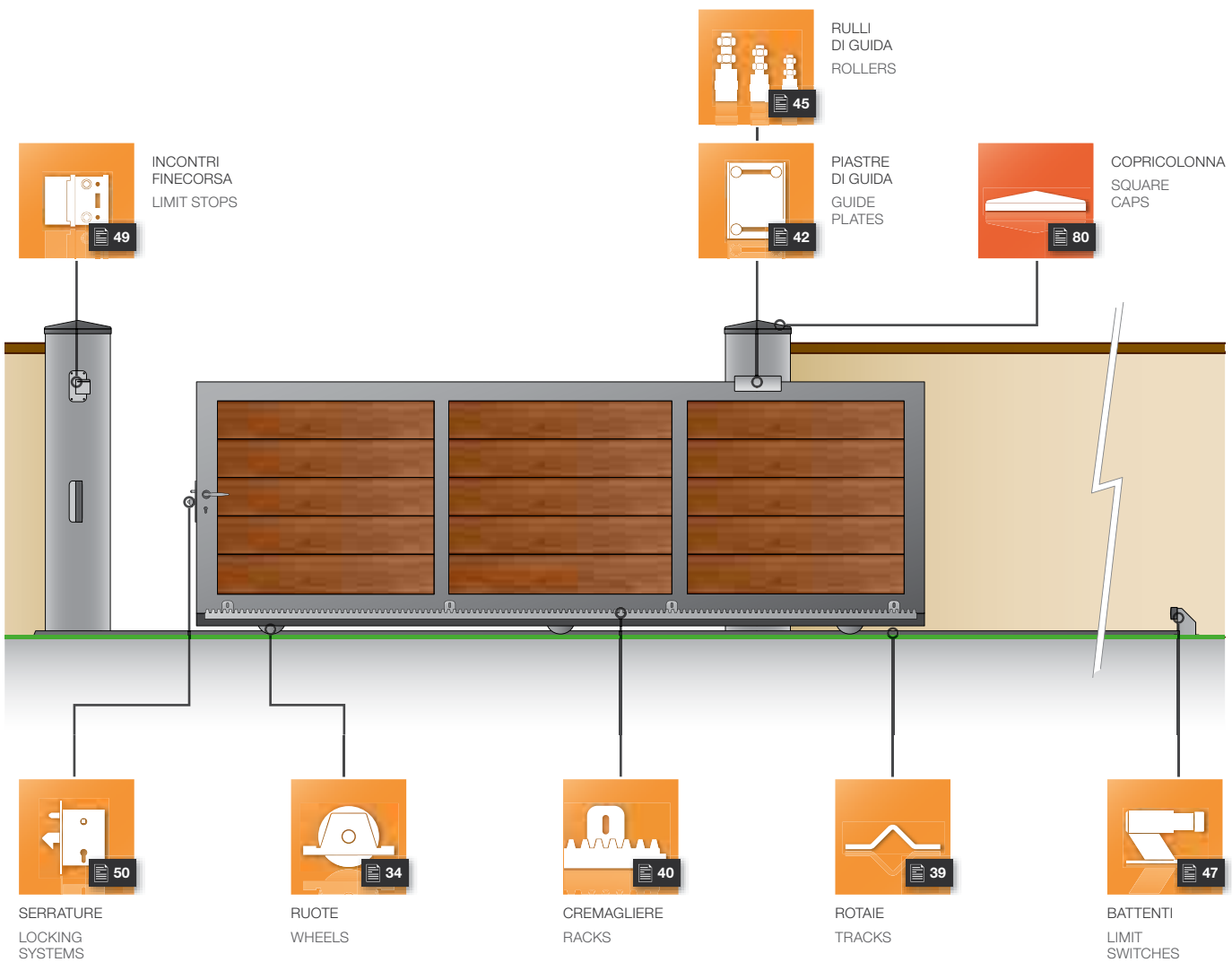

1 un cuscinetto  
one bearing

2 due cuscinetti  
two bearings



## RUOTE WHEELS

Ruote zincate con bullone semplice  
Galvanized wheels with bolt

- *Produzione ruote a disegno su specifiche del cliente (quantità da concordare)*
- *Custom wheels on demand (quantity to be agreed)*



### Durata cuscinetto / Bearing's lifetime

| DIAMETRO<br>DIAMETER | PERCORRENZA<br>DISTANCE |
|----------------------|-------------------------|
| 50 mm                | 120 km                  |
| 60 mm                | 150 km                  |
| 80 mm                | 220 km                  |
| 90 mm                | 250 km                  |
| 100 mm               | 280 km                  |
| 120 mm               | 345 km                  |
| 140 mm               | 400 km                  |
| 160 mm               | 450 km                  |
| 200 mm               | 580 km                  |
| 250 mm               | 750 km                  |
| 300 mm               | 900 km                  |

### Durata in anni / Duration/years

PERCORRENZA (km) x 1000  
DISTANCE (km)

365 x PERCORRENZA GIORNALIERA (m)  
DAILY DISTANCE (m)

- *Disponibile versione inox su richiesta (quantità da concordare)*
- *Stainless steel version available on demand (quantity to be agreed)*

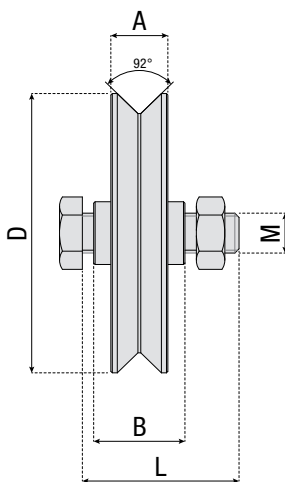

Con gola a V  
With V groove

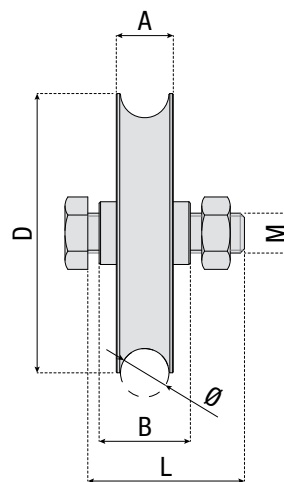

Con gola tonda  
With half-round groove

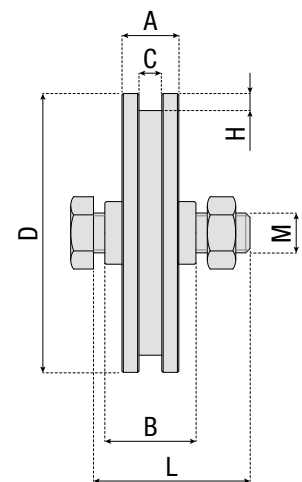



Con gola quadra  
With square groove



Con gola a V / With V groove

|          |  | D<br>(mm) | A<br>(mm) | B<br>(mm) | GOLA<br>GROOVE | PORTATA<br>CAPACITY | BULLONE<br>BOLT |  |
|----------|---|-----------|-----------|-----------|----------------|---------------------|-----------------|---|
| <b>1</b> | 100.50  | 48        | 17        | 24        | V 92°          | 100 kg              | M10x45          | 10  |
|          | 100.60  | 58        | 20        | 26        | V 92°          | 200 kg              | M12x50          | 10  |
|          | 100.80  | 78        | 20        | 32        | V 92°          | 250 kg              | M14x60          | 6   |
|          | 100.90  | 88        | 20        | 32        | V 92°          | 250 kg              | M14x60          | 6   |
|          | 100.100   | 98        | 20        | 32        | V 92°          | 250 kg              | M14x60          | 4   |
|          | 100.120   | 118       | 20        | 32        | V 92°          | 250 kg              | M14x60          | 4   |
|          | 100.140   | 138       | 20        | 32        | V 92°          | 250 kg              | M14x60          | 4   |
|          | 100.160   | 158       | 20        | 32        | V 92°          | 250 kg              | M14x60          | 2   |
|          | 100.200   | 198       | 20        | 32        | V 92°          | 250 kg              | M14x60          | 2   |
|          | <b>2</b>  | 101.80    | 78        | 30        | 34             | V 92°               | 500 kg          | M14x70  |
| 101.100  |   | 98        | 30        | 34        | V 92°          | 500 kg              | M14x70          | 4   |
| 101.120  |   | 118       | 30        | 34        | V 92°          | 500 kg              | M14x70          | 4   |
| 101.140  |   | 138       | 30        | 34        | V 92°          | 500 kg              | M14x70          | 4   |
| 101.160  |   | 158       | 30        | 34        | V 92°          | 500 kg              | M14x70          | 2   |
| 101.200  |   | 198       | 30        | 34        | V 92°          | 500 kg              | M14x70          | 2   |
| 101.250  |   | 248       | 38        | 48        | V 92°          | 800 kg              | M16x80          | 2   |
| 101.300  |   | 298       | 38        | 48        | V 92°          | 800 kg              | M16x80          | 2   |

Con gola tonda / With half-round groove

|          |  | D<br>(mm) | A<br>(mm) | B<br>(mm) | Ø GOLA<br>Ø GROOVE | PORTATA<br>CAPACITY | BULLONE<br>BOLT |  |
|----------|---|-----------|-----------|-----------|--------------------|---------------------|-----------------|---|
| <b>1</b> | 102.60  | 58        | 20        | 26        | 16                 | 200 kg              | M12x50          | 10  |
|          | 102.80  | 78        | 20        | 32        | 16                 | 250 kg              | M14x60          | 6   |
|          | 102.90  | 88        | 20        | 32        | 16                 | 250 kg              | M14x60          | 6   |
|          | 102.100   | 98        | 20        | 32        | 16                 | 250 kg              | M14x60          | 4   |
|          | 102.120   | 118       | 20        | 32        | 16                 | 250 kg              | M14x60          | 4   |
|          | 102.140   | 138       | 20        | 32        | 16                 | 250 kg              | M14x60          | 4   |
|          | 102.160   | 158       | 20        | 32        | 16                 | 250 kg              | M14x60          | 2   |
|          | 102.200   | 198       | 20        | 32        | 16                 | 250 kg              | M14x60          | 2   |
|          | 103.80  | 78        | 24        | 32        | 20                 | 250 kg              | M14x60          | 6   |
|          | 103.90  | 88        | 24        | 32        | 20                 | 250 kg              | M14x60          | 6   |
| <b>2</b> | 103.100   | 98        | 24        | 32        | 20                 | 250 kg              | M14x60          | 4   |
|          | 103.120   | 118       | 24        | 32        | 20                 | 250 kg              | M14x60          | 4   |
|          | 103.140   | 138       | 24        | 32        | 20                 | 250 kg              | M14x60          | 4   |
|          | 104.80  | 78        | 30        | 34        | 20                 | 500 kg              | M14x70          | 6   |
|          | 104.100   | 98        | 30        | 34        | 20                 | 500 kg              | M14x70          | 4   |
|          | 104.120   | 118       | 30        | 34        | 20                 | 500 kg              | M14x70          | 4   |
|          | 104.140   | 138       | 30        | 34        | 20                 | 500 kg              | M14x70          | 4   |
|          | 104.160   | 158       | 30        | 34        | 20                 | 500 kg              | M14x70          | 2   |
|          | 104.200   | 198       | 30        | 34        | 20                 | 500 kg              | M14x70          | 2   |
|          | 104.250   | 248       | 38        | 48        | 20                 | 800 kg              | M16x80          | 2   |
| 104.300  | 298   | 38        | 48        | 20        | 800 kg             | M16x80              | 2               |   |

Con gola quadra / With square groove

|          |  | D<br>(mm) | A<br>(mm) | B<br>(mm) | C x H | PORTATA<br>CAPACITY | BULLONE<br>BOLT |  |
|----------|---|-----------|-----------|-----------|-------|---------------------|-----------------|---|
| <b>1</b> | 105.60  | 58        | 20        | 32        | 8x6   | 200 kg              | M12x50          | 10  |
|          | 105.80  | 78        | 20        | 32        | 8x6   | 250 kg              | M14x60          | 6   |
|          | 105.90  | 88        | 20        | 32        | 8x6   | 250 kg              | M14x60          | 4   |
|          | 105.100   | 98        | 20        | 32        | 8x6   | 250 kg              | M14x60          | 4   |
|          | 105.120   | 118       | 20        | 32        | 8x6   | 250 kg              | M14x60          | 4   |
|          | 105.140   | 138       | 20        | 32        | 8x6   | 250 kg              | M14x60          | 2   |
|          | 105.160   | 158       | 20        | 32        | 8x6   | 250 kg              | M14x60          | 2   |
|          | 105.200   | 198       | 20        | 32        | 8x6   | 250 kg              | M14x60          | 2   |
| <b>2</b> | 106.100   | 98        | 30        | 34        | 20x10 | 500 kg              | M14x70          | 4   |
|          | 106.120   | 118       | 30        | 34        | 20x10 | 500 kg              | M14x70          | 4   |
|          | 106.140   | 138       | 30        | 34        | 20x10 | 500 kg              | M14x70          | 2   |
|          | 106.160   | 158       | 30        | 34        | 20x10 | 500 kg              | M14x70          | 2   |
|          | 106.200   | 198       | 30        | 34        | 20x10 | 500 kg              | M14x70          | 2   |

Ruote zincate con supporto interno  
Galvanized wheels with internal support bracket

1 un cuscinetto  
one bearing

2 due cuscinetti  
two bearings

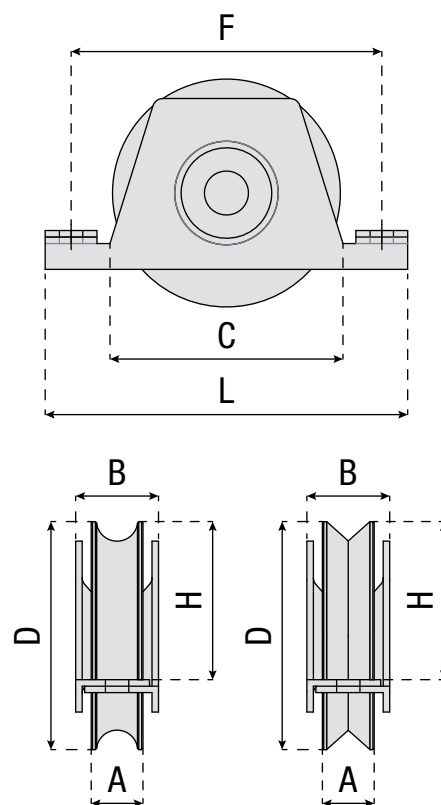

Con gola a V / With V groove

|   |         | D (mm) | A (mm) | B (mm) | C (mm) | H (mm) | L (mm) | F (mm) | GOLA GROOVE | PORTATA CAPACITY | Ø FORI Ø HOLES |   |
|---|---------|--------|--------|--------|--------|--------|--------|--------|-------------|------------------|----------------|---|
| 1 | 109.80  | 78     | 20     | 33     | 90     | 53     | 140    | 120    | V 92°       | 250 kg           | 9              | 6 |
|   | 109.90  | 88     | 20     | 33     | 90     | 58     | 140    | 120    | V 92°       | 250 kg           | 9              | 6 |
|   | 109.100 | 98     | 20     | 33     | 90     | 73     | 140    | 120    | V 92°       | 250 kg           | 9              | 4 |
|   | 109.120 | 118    | 20     | 33     | 130    | 89     | 190    | 165    | V 92°       | 250 kg           | 9              | 2 |
|   | 109.140 | 138    | 20     | 33     | 130    | 99     | 190    | 165    | V 92°       | 250 kg           | 9              | 2 |
| 2 | 110.90  | 88     | 30     | 45     | 90     | 58     | 140    | 120    | V 92°       | 500 kg           | 9              | 6 |
|   | 110.100 | 98     | 30     | 45     | 90     | 73     | 140    | 120    | V 92°       | 500 kg           | 9              | 2 |
|   | 110.120 | 118    | 30     | 45     | 130    | 89     | 190    | 165    | V 92°       | 500 kg           | 9              | 2 |
|   | 110.140 | 138    | 30     | 45     | 130    | 99     | 190    | 165    | V 92°       | 500 kg           | 9              | 2 |
|   | 110.160 | 158    | 30     | 41     | 170    | 127    | 260    | 230    | V 92°       | 500 kg           | 9              | 2 |
|   | 110.200 | 198    | 30     | 41     | 200    | 147    | 260    | 230    | V 92°       | 500 kg           | 9              | 2 |

Con gola tonda / With half-round groove

|   |         | D (mm) | A (mm) | B (mm) | C (mm) | H (mm) | L (mm) | F (mm) | Ø GOLA Ø GROOVE | PORTATA CAPACITY | Ø FORI Ø HOLES |   |
|---|---------|--------|--------|--------|--------|--------|--------|--------|-----------------|------------------|----------------|---|
| 1 | 111.80  | 78     | 20     | 33     | 90     | 53     | 140    | 120    | 16              | 250 kg           | 9              | 6 |
|   | 111.90  | 88     | 20     | 33     | 90     | 58     | 140    | 120    | 16              | 250 kg           | 9              | 6 |
|   | 111.100 | 99     | 20     | 33     | 90     | 73     | 140    | 120    | 16              | 250 kg           | 9              | 4 |
|   | 111.120 | 118    | 20     | 33     | 130    | 89     | 190    | 165    | 16              | 250 kg           | 9              | 2 |
|   | 111.140 | 138    | 20     | 33     | 130    | 99     | 190    | 165    | 16              | 250 kg           | 9              | 2 |
|   | 112.80  | 78     | 24     | 33     | 90     | 53     | 140    | 120    | 20              | 250 kg           | 9              | 6 |
|   | 112.90  | 88     | 24     | 33     | 90     | 58     | 140    | 120    | 20              | 250 kg           | 9              | 6 |
|   | 112.100 | 98     | 24     | 33     | 90     | 73     | 140    | 120    | 20              | 250 kg           | 9              | 4 |
|   | 112.120 | 118    | 24     | 33     | 130    | 89     | 190    | 165    | 20              | 250 kg           | 9              | 2 |
|   | 112.140 | 138    | 24     | 33     | 130    | 99     | 190    | 165    | 20              | 250 kg           | 9              | 2 |
| 2 | 113.90  | 88     | 30     | 45     | 90     | 58     | 140    | 120    | 20              | 500 kg           | 9              | 6 |
|   | 113.100 | 98     | 30     | 45     | 90     | 73     | 140    | 120    | 20              | 500 kg           | 9              | 4 |
|   | 113.120 | 118    | 30     | 45     | 130    | 89     | 190    | 165    | 20              | 500 kg           | 9              | 2 |
|   | 113.140 | 138    | 30     | 45     | 130    | 99     | 190    | 165    | 20              | 500 kg           | 9              | 2 |
|   | 113.160 | 158    | 30     | 41     | 170    | 127    | 260    | 230    | 20              | 500 kg           | 9              | 2 |
|   | 113.200 | 198    | 30     | 41     | 200    | 147    | 260    | 230    | 20              | 500 kg           | 9              | 2 |

Ruota con supporto esterno  
Wheel with external support bracket

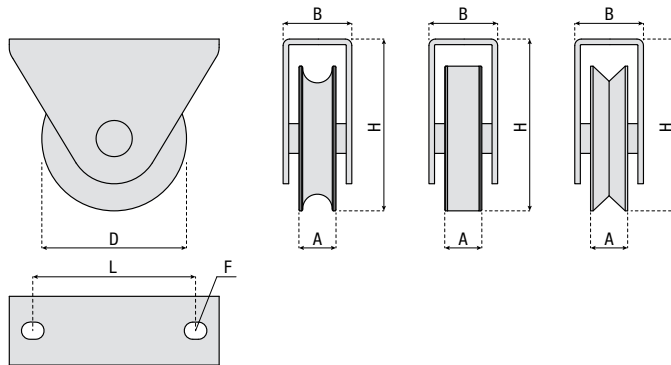

Con gola piana / With plane

| 00101100 | D (mm) | A (mm) | B (mm) | H (mm) | L (mm) | F (mm)     | GOLA GROOVE   | PORTATA CAPACITY |   |
|----------|--------|--------|--------|--------|--------|------------|---------------|------------------|---|
| 125.60.P | 58     | 20     | 26     | 64     | 63,5   | 6,5 X 8,5  | PIANA / PLANE | 200 kg           | 6 |
| 125.70.P | 70     | 20     | 37     | 92     | 90     | 8,5 X 12,5 | PIANA / PLANE | 200 kg           | 6 |

Con gola a V / With V groove

| 00101100 | D (mm)  | A (mm) | B (mm) | H (mm) | L (mm) | F (mm) | GOLA GROOVE | PORTATA CAPACITY |        |   |
|----------|---------|--------|--------|--------|--------|--------|-------------|------------------|--------|---|
| 1        | 125.60  | 58     | 20     | 26     | 64     | 63,5   | 6,5 X 8,5   | V 92°            | 200 kg | 6 |
|          | 125.80  | 78     | 20     | 37     | 96     | 90     | 8,5 X 12,5  | V 92°            | 250 kg | 6 |
|          | 125.100 | 98     | 20     | 37     | 106    | 90     | 8,5 X 12,5  | V 92°            | 250 kg | 4 |

Con gola tonda / With half-round groove

| 00101100 | D (mm)  | A (mm) | B (mm) | H (mm) | L (mm) | F (mm) | Ø GOLA Ø GROOVE | PORTATA CAPACITY |        |   |
|----------|---------|--------|--------|--------|--------|--------|-----------------|------------------|--------|---|
| 1        | 126.80  | 78     | 20     | 37     | 96     | 90     | 8,5 X 12,5      | 16               | 250 kg | 6 |
|          | 126.100 | 98     | 20     | 37     | 106    | 90     | 8,5 X 12,5      | 16               | 250 kg | 6 |
|          | 127.80  | 78     | 24     | 37     | 96     | 140    | 8,5 X 12,5      | 20               | 250 kg | 6 |
|          | 127.100 | 98     | 24     | 37     | 106    | 190    | 8,5 X 12,5      | 20               | 250 kg | 6 |

Ruota con fiancate a saldare  
Wheel with side panels to be welded

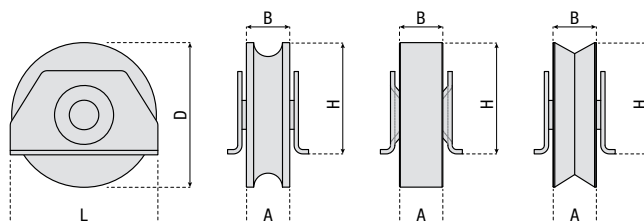

Con gola piana / With plane

| 00101100 | D (mm) | A (mm) | B (mm) | H (mm) | L (mm) | GOLA GROOVE   | PORTATA CAPACITY |   |
|----------|--------|--------|--------|--------|--------|---------------|------------------|---|
| 129.90.P | 88     | 20     | 33     | 71     | 100    | PIANA / PLANE | 250 kg           | 6 |

Con gola a V / With V groove

| 00101100 | D (mm)  | A (mm) | B (mm) | H (mm) | L (mm) | GOLA GROOVE | PORTATA CAPACITY |        |   |
|----------|---------|--------|--------|--------|--------|-------------|------------------|--------|---|
| 1        | 129.80  | 78     | 20     | 33     | 66     | 100         | V 92°            | 250 kg | 6 |
|          | 129.90  | 88     | 20     | 33     | 71     | 100         | V 92°            | 250 kg | 6 |
|          | 129.100 | 98     | 20     | 33     | 76     | 100         | V 92°            | 250 kg | 6 |
|          | 129.120 | 118    | 20     | 33     | 96     | 120         | V 92°            | 250 kg | 2 |
|          | 129.140 | 138    | 20     | 33     | 106    | 120         | V 92°            | 250 kg | 2 |
| 2        | 128.90  | 88     | 30     | 45     | 71     | 100         | V 92°            | 500 kg | 6 |
|          | 128.100 | 98     | 30     | 45     | 76     | 100         | V 92°            | 500 kg | 6 |
|          | 128.120 | 118    | 30     | 45     | 96     | 120         | V 92°            | 500 kg | 2 |
|          | 128.140 | 138    | 30     | 45     | 106    | 120         | V 92°            | 500 kg | 2 |

Con gola tonda / With half-round groove

| 00101100 | D (mm)  | A (mm) | B (mm) | H (mm) | L (mm) | Ø GOLA Ø GROOVE | PORTATA CAPACITY |        |   |
|----------|---------|--------|--------|--------|--------|-----------------|------------------|--------|---|
| 1        | 130.80  | 78     | 20     | 33     | 66     | 100             | 16               | 250 kg | 6 |
|          | 130.90  | 88     | 20     | 33     | 71     | 100             | 16               | 250 kg | 6 |
|          | 130.100 | 98     | 20     | 33     | 76     | 100             | 16               | 250 kg | 2 |
|          | 130.120 | 118    | 20     | 33     | 96     | 120             | 16               | 250 kg | 2 |
|          | 130.140 | 138    | 20     | 33     | 106    | 120             | 16               | 250 kg | 2 |
| 2        | 131.90  | 88     | 30     | 45     | 71     | 100             | 20               | 500 kg | 6 |
|          | 131.100 | 98     | 30     | 45     | 76     | 100             | 20               | 500 kg | 6 |
|          | 131.120 | 118    | 30     | 45     | 96     | 120             | 20               | 500 kg | 2 |
|          | 131.140 | 138    | 30     | 45     | 106    | 120             | 20               | 500 kg | 2 |



Ruota per basculanti con gola tonda  
Overhead gate wheels with round groove

1 un cuscinetto  
one bearing

2 due cuscinetti  
two bearings



132 / 133



134.100.5

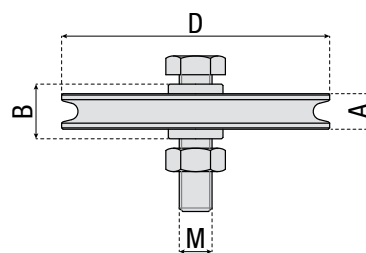

|           | D (mm) | A (mm) | B (mm) | Ø GOLA Ø GROOVE | PORTATA CAPACITY | BULLONE BOLT | NOTE NOTES      |    |
|-----------|--------|--------|--------|-----------------|------------------|--------------|-----------------|----|
| 132.60    | 58     | 13     | 20     | 6               | 200 kg           | M10x40       | ACCIAIO / STEEL | 20 |
| 132.60.5  | 58     | 13     | 20     | 5               | 200 kg           | M10x40       | ACCIAIO / STEEL | 20 |
| 132.80    | 78     | 13     | 20     | 6               | 200 kg           | M12x50       | ACCIAIO / STEEL | 12 |
| 132.90    | 88     | 13     | 20     | 6               | 200 kg           | M12x50       | ACCIAIO / STEEL | 12 |
| 132.100   | 98     | 13     | 20     | 6               | 200 kg           | M12x50       | ACCIAIO / STEEL | 10 |
| 132.120   | 118    | 13     | 20     | 6               | 200 kg           | M12x50       | ACCIAIO / STEEL | 8  |
| 133.60    | 58     | 15     | 20     | 8               | 200 kg           | M10x40       | ACCIAIO / STEEL | 20 |
| 133.80    | 78     | 15     | 20     | 8               | 200 kg           | M12x50       | ACCIAIO / STEEL | 12 |
| 133.90    | 88     | 15     | 20     | 8               | 200 kg           | M12x50       | ACCIAIO / STEEL | 12 |
| 133.100   | 98     | 15     | 20     | 8               | 200 kg           | M12x50       | ACCIAIO / STEEL | 10 |
| 133.120   | 118    | 15     | 20     | 8               | 200 kg           | M12x50       | ACCIAIO / STEEL | 8  |
| 133.200   | 198    | 18     | 21     | 8               | 250 kg           | M14x60       | ACCIAIO / STEEL | 4  |
| 134.100.5 | 100    | 18     | 26     | 5               | 100 kg           | M12x50       | NYLON / NYLON   | 10 |

Ruota 4" e 6"  
4" and 6" wheel

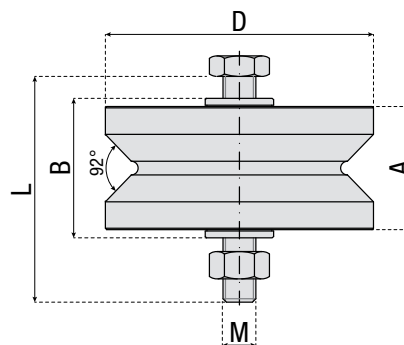

|          | D (mm) | A (mm) | B (mm) | Ø GOLA Ø GROOVE | PORTATA CAPACITY | BULLONE BOLT       | FINITURA FINISHING                       |   |
|----------|--------|--------|--------|-----------------|------------------|--------------------|--|---|
| 135.100  | 98     | 45     | 51     | V 92°           | 2200 lb          | UNC 1/2" x 3 1/4"  | ACCIAIO ZINCATO / STEEL GALVANIZED       | 1 |
| 135.100G | 98     | 45     | 51     | V 92°           | 2200 lb          | UNC 1/2" x 3 1/4"  | ZINCATO GIALLO / YELLOW GALVANIZED STEEL | 1 |
| 135.148  | 148    | 45     | 51     | V 92°           | 2800 lb          | UNC 5/8" x 3" 1/4" | ACCIAIO ZINCATO / STEEL GALVANIZED       | 1 |
| 135.148G | 148    | 45     | 51     | V 92°           | 2800 lb          | UNC 5/8" x 3" 1/4" | ZINCATO GIALLO / YELLOW GALVANIZED STEEL | 1 |

Ruota con supporto rotante a saldare  
Swing folding gate galvanized wheel with rotating support

*new*

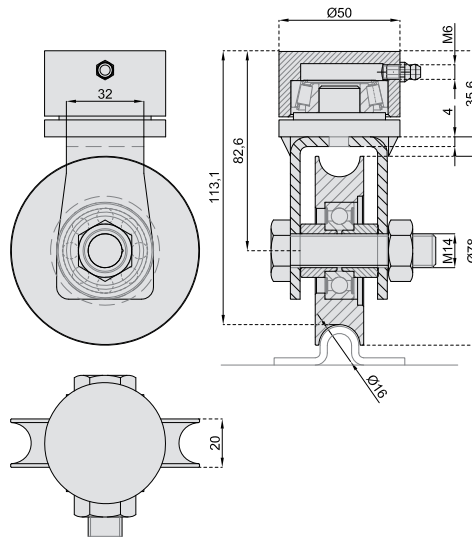

|          |   |
|----------|---|
|          |   |
| 140.2.80 | 2 |

# ROTAIE TRACKS

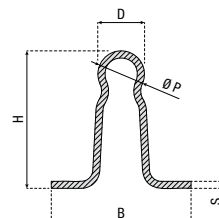
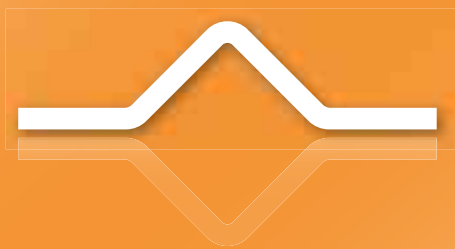

Rotaia a cementare per cancelli e portoni  
Track to be cemented for gates and doors

*new*



| 00101100 | B (mm) | H (mm) | D (mm) | S (mm) | Ø P (mm) | LUNGHEZZA LENGHT |
|----------|--------|--------|--------|--------|----------|------------------|
| 181.3    | 50     | 50     | 16     | 2,5    | 10       | 3000 mm          |
| 181.6    | 50     | 50     | 16     | 2,5    | 10       | 6000 mm          |
| 182.3    | 60     | 59     | 20     | 3      | 14       | 3000 mm          |
| 182.6    | 60     | 59     | 20     | 3      | 14       | 6000 mm          |

Piastrina di giunzione per rotaie a cementare  
Joint plate for tracks to be cemented

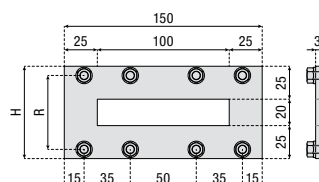

| 00101100 | R (mm) | H (mm) |    |
|----------|--------|--------|----|
| 183.1    | 56     | 70     | 20 |
| 183.2    | 66     | 80     | 20 |

Rotaia a fissare per cancelli e portoni, con gola tonda  
Track to be fixed for gates and doors, with half-round groove

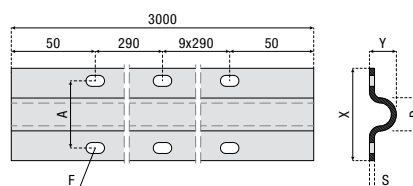

| 00101100 | D (mm) | X (mm) | Y (mm) | A (mm) | F (mm)  | S (mm) | FINITURA FINISHING       |
|----------|--------|--------|--------|--------|---------|--------|--------------------------|
| 186.3    | 16     | 53     | 16     | 38     | ø6,5x10 | 3      | DX51D ZINCATO GALVANIZED |
| 187.3    | 20     | 55     | 16     | 40     | ø6,5x10 | 3      |                          |
| 2186.3   | 16     | 53     | 16     | 38     | ø6,5x10 | 3      | AISI304 INOX             |
| 2187.3   | 20     | 55     | 16     | 40     | ø6,5x10 | 3      | STAINLESS STEEL          |

Versione inox su richiesta, a quantità  
Stainless steel track, quantity on demand

Rotaia a fissare per cancelli e portoni, con gola a V  
Track to be fixed for gates and doors, with V groove

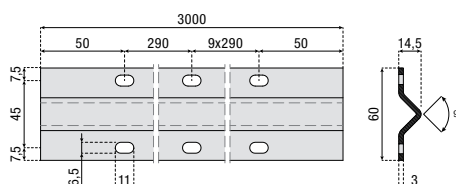

| 00101100 | L (mm) |
|----------|--------|
| 190.3    | 3000   |

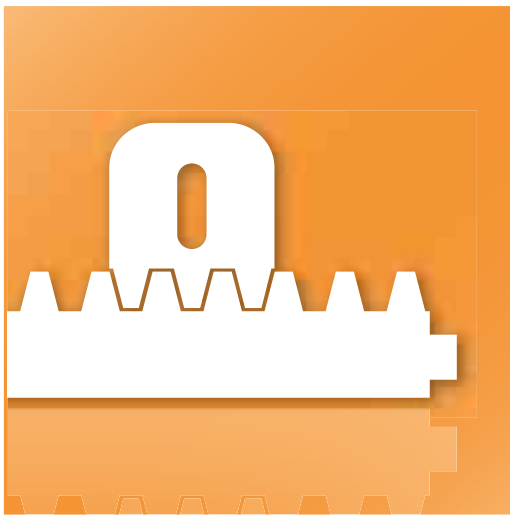

# CREMAGLIERE RACKS

Cremagliera  
Rack

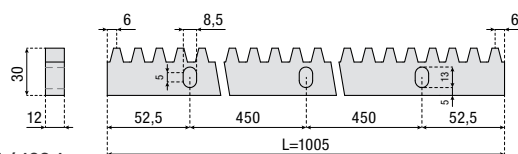

191.1 / 192.1

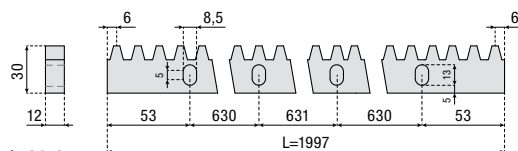

191.2 / 192.2

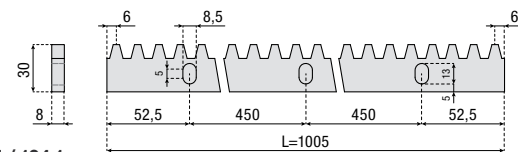

193.1 / 194.1

|  | H x L (mm) | MODULO<br>MODULE | L (mm) | TIPO<br>TYPE                       |
|---|------------|------------------|--------|------------------------------------|
| 191.1   | 30x12      | 4                | 1005   | PIOLI A SALDARE / PIP TO BE WELDED |
| 191.2   | 30x12      | 4                | 1997   | PIOLI A SALDARE / PIP TO BE WELDED |
| 192.1   | 30x12      | 4                | 1005   | PIOLI A FISSARE / PIP TO BE FIXED  |
| 192.2   | 30x12      | 4                | 1997   | PIOLI A FISSARE / PIP TO BE FIXED  |
| 193.1   | 30x8       | 4                | 1005   | PIOLI A SALDARE / PIP TO BE WELDED |
| 194.1   | 30x8       | 4                | 1005   | PIOLI A FISSARE / PIP TO BE FIXED  |

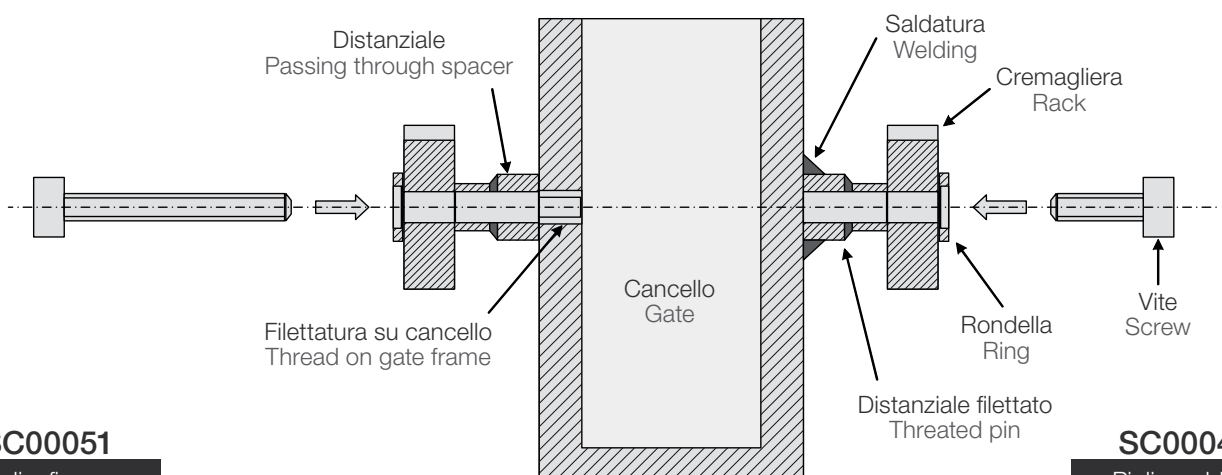

SC00051

Pioli a fissare  
Pip to be fixed

SC00041

Pioli a saldare  
Pip to be welded

Cremagliera  
 Rack

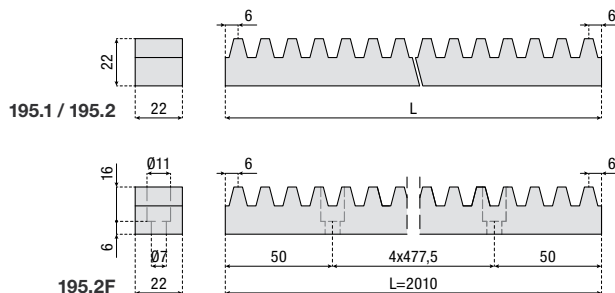

| 00101100 | H x L (mm) | MODULO<br>MODULE | L (mm) | TIPO<br>TYPE    |
|----------|------------|------------------|--------|-----------------|
| 195.1    | 22x22      | 4                | 1005   | -               |
| 195.2    | 22x22      | 4                | 1997   | -               |
| 195.2F   | 22x22      | 4                | 2010   | M6 DIN912 (5px) |

Cremagliera  
 Rack

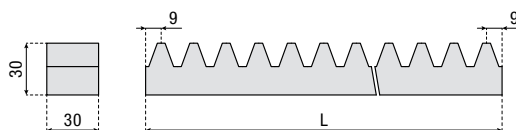

| 00101100 | H x L (mm) | MODULO<br>MODULE | L (mm) | TIPO<br>TYPE |
|----------|------------|------------------|--------|--------------|
| 196.1    | 30x30      | 6                | 998    | -            |
| 196.2    | 30x30      | 6                | 1997   | -            |

Cremagliera in nylon con anima in acciaio  
 Nylon rack with steel core

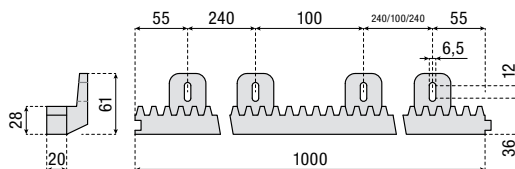

| 00101100 | H x L (mm) | MODULO<br>MODULE | L (mm) |
|----------|------------|------------------|--------|
| 197.1    | 28x22      | 4                | 1000   |

Piolino  
 Pip



SC00041

SC00051

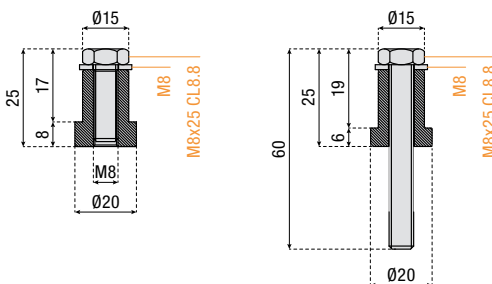

SC00041

SC00051

| 00101100 | TIPO<br>TYPE             |         |
|----------|--------------------------|---------|
| SC00041  | A SILDARE / TO BE WELDED | MIN. 50 |
| SC00051  | A FISSARE / TO BE FIXED  | MIN. 50 |

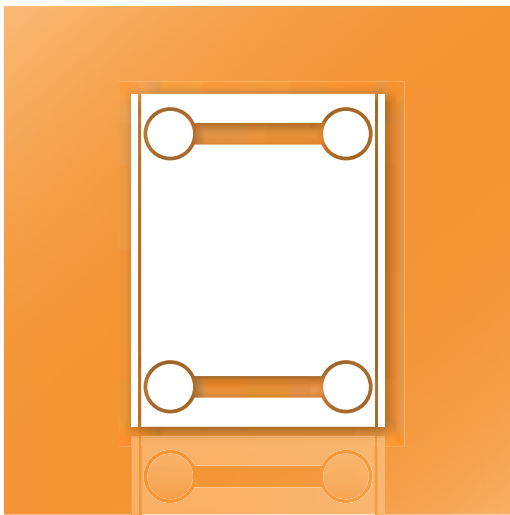

## PIASTRE DI GUIDA GUIDE PLATES

■ Piastre di guida a saldare  
Guide plates to be welded

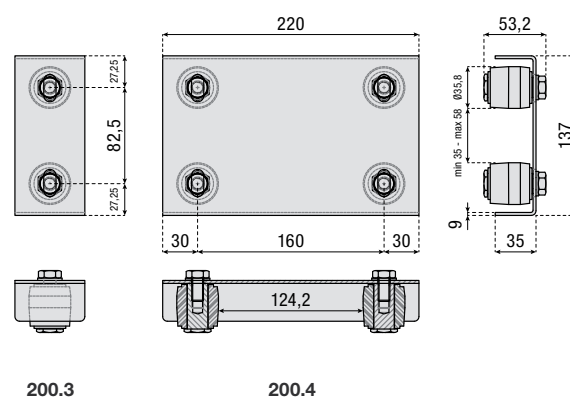

| 00101100 | N° RULLI<br>N° ROLLERS |   |
|----------|------------------------|---|
| 200.3    | 2                      | 8 |
| 200.4    | 4                      | 4 |

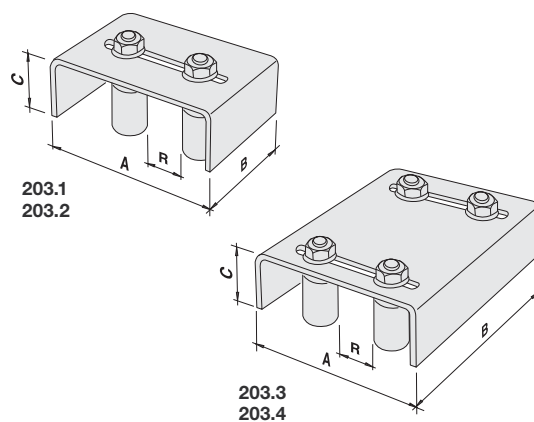
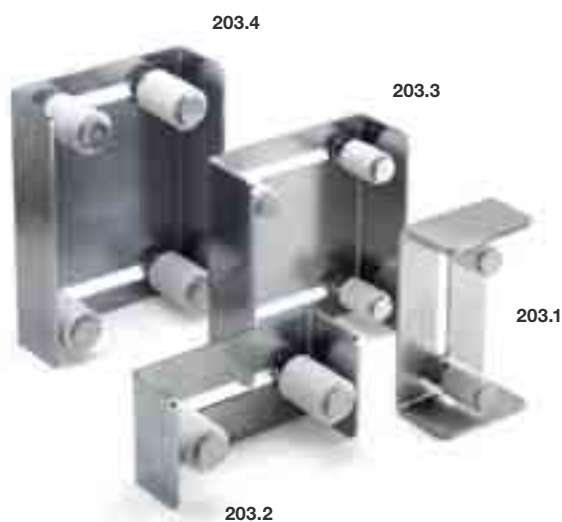

■ Piastre di guida a saldare con asola lunga per colonne in ferro  
Guide plates to be welded with long hole for iron columns



| 00101100 | A (mm) | B (mm) | C (mm) | R <sub>MIN-MAX</sub> (mm) | N° RULLI<br>N° ROLLERS |   |
|----------|--------|--------|--------|---------------------------|------------------------|---|
| 203.1    | 180    | 100    | 65     | 30-100                    | 2-Ø30                  | 4 |
| 203.2    | 190    | 100    | 65     | 40-80                     | 2-Ø42                  | 4 |
| 203.3    | 180    | 200    | 70     | 30-100                    | 4-Ø30                  | 4 |
| 203.4    | 190    | 250    | 70     | 40-80                     | 4-Ø42                  | 4 |

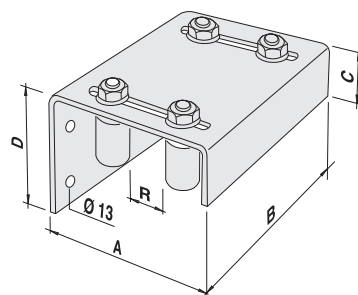
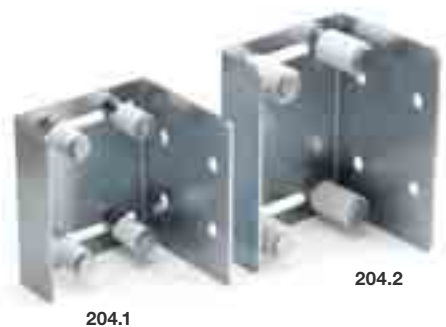

Piastre di guida a fissare con asola lunga  
Guide plates to be fixed with long hole



|  | A (mm) | B (mm) | C (mm) | D (mm) | R <sub>MIN-MAX</sub> (mm) | N° RULLI<br>N° ROLLERS |  |
|---|--------|--------|--------|--------|---------------------------|------------------------|---|
| 204.1   | 180    | 200    | 70     | 160    | 30-100                    | 4-Ø30                  | 4   |
| 204.2   | 190    | 250    | 70     | 160    | 40-80                     | 4-Ø42                  | 4   |

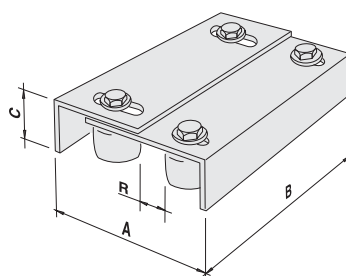

Piastre di guida regolabili a saldare  
Adjustable guide plates to be welded



|  | A <sub>MIN-MAX</sub> (mm) | B (mm) | C (mm) | R <sub>MIN-MAX</sub> (mm) | N° RULLI<br>N° ROLLERS |  |
|---|---------------------------|--------|--------|---------------------------|------------------------|---|
| 205.3   | 133-182                   | 200    | 50     | 40-60                     | 4-Ø36                  | 4   |
| 205.4   | 200-250                   | 350    | 72     | 60-100                    | 4-Ø42                  | 4   |

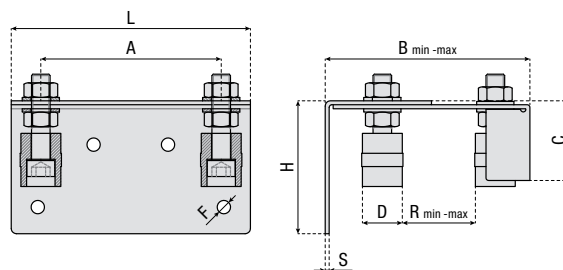

Piastre di guida regolabili a fissare  
Adjustable guide plates to be fixed

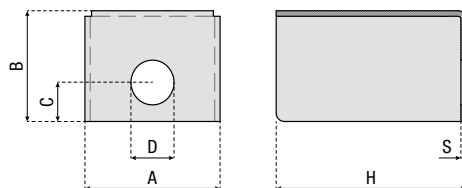

|  | R <sub>MIN-MAX</sub> (mm) | L (mm) | H (mm) | A (mm) | R <sub>MIN-MAX</sub> (mm) | C (mm) | D (mm) | F (mm) | S (mm) |  |
|---|---------------------------|--------|--------|--------|---------------------------|--------|--------|--------|--------|---|
| 208.1   | 40-80                     | 180    | 100    | 136    | 215-225                   | 60     | 30     | 10     | 3      | 2   |
| 208.2   | 80-120                    | 280    | 160    | 228    | 154-198                   | 77     | 40     | 10     | 4      | 2   |

Protezione antinfortunistica per rulli in nylon  
Accident prevention for nylon roller



|  | H (mm) | A (mm) | B (mm) | C (mm) | D (mm) | S (mm) | APPLICAZIONE<br>APPLICATION |  |
|---|--------|--------|--------|--------|--------|--------|-----------------------------|---|
| 209.02  | 56     | 40,5   | 32     | 11     | 14,1   | 2      | 220.2                       | 12  |
| 209.03  | 71     | 50,5   | 39,8   | 14     | 16,1   | 2      | 220.3                       | 12  |

Angolare di guida regolabili per cancelli scorrevoli  
Adjustable corner guide for sliding gates

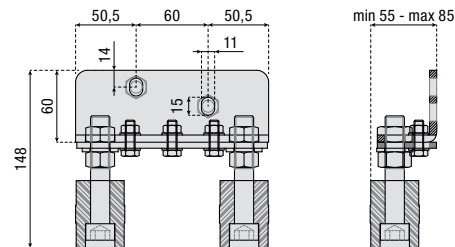

|        |                        |   |
|--------|------------------------|---|
|        | N° RULLI<br>N° ROLLERS |   |
| 211.3B | 2 x D40 (220.3)        | 2 |

Staffa di guida a due rulli a fissare  
Bracket guide to be fixed with two rollers

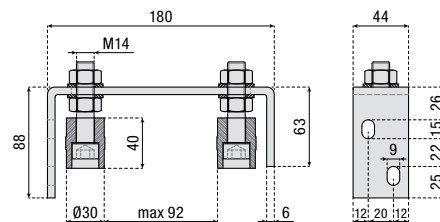

|       |   |
|-------|---|
|       |   |
| 212.0 | 4 |

Staffa di guida a fissare  
A bracket guide to be fixed

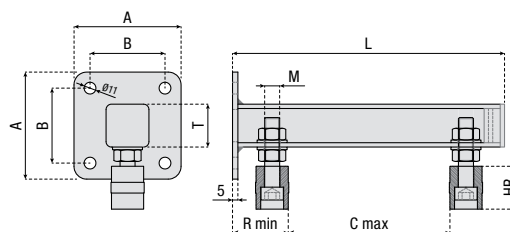

|        | A (mm) | B (mm) | C <sub>MAX</sub> (mm) | L (mm) | M (mm) | R <sub>MIN</sub> (mm) | T (mm) | HR (mm) | DRxHR (mm) |   |
|--------|--------|--------|-----------------------|--------|--------|-----------------------|--------|---------|------------|---|
| 213.2B | 100    | 70     | 150                   | 250    | 14     | 53                    | 40     | 40      | D30x40     | 2 |
| 213.3B | 120    | 90     | 188                   | 300    | 16     | 58                    | 50     | 56      | D40x56     | 2 |

Angolare di guida regolabile per cancelli scorrevoli  
Adjustable corner guide for sliding gates

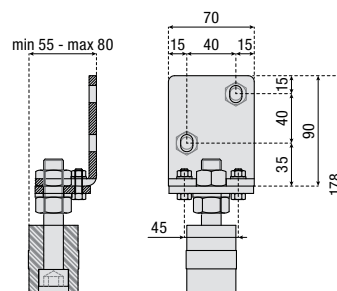



|        |                        |   |
|--------|------------------------|---|
|        | N° RULLI<br>N° ROLLERS |   |
| 214.3B | 1 x D40 (220.3)        | 2 |

# RULLI DI GUIDA ROLLERS

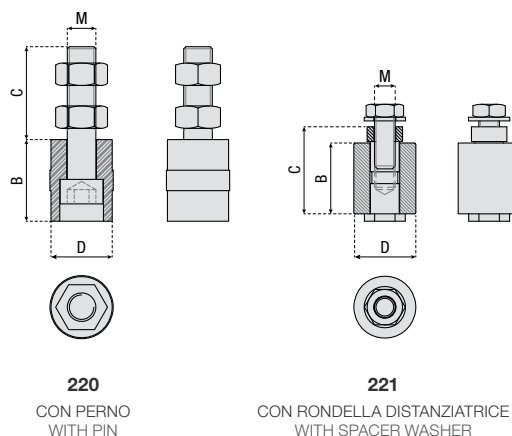

Rulli guida in nylon bianco  
White nylon guide rollers

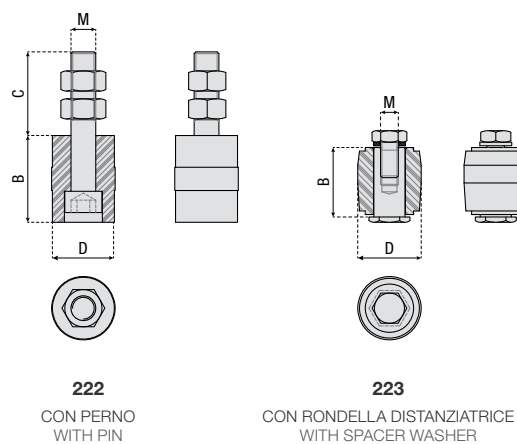

|  | D (mm) | B (mm) | C (mm) | M (mm) |  |
|---|--------|--------|--------|--------|---|
| 220.1   | 25     | 40     | 42     | 12     | 20  |
| 220.2   | 30     | 40     | 45     | 14     | 16  |
| 220.3   | 40     | 56     | 52     | 16     | 12  |
| 220.4   | 52     | 48     | 48     | 20     | 12  |
| 221.1   | 35     | 30     | 36     | 10     | 20  |
| 221.2   | 42     | 48     | 60     | 14     | 12  |
| 221.3   | 52     | 48     | 64     | 16     | 12  |

Rulli guida in nylon nero  
Black nylon guide rollers



|  | D (mm) | B (mm) | C (mm) | M (mm) |  |
|---|--------|--------|--------|--------|---|
| 222.1   | 25     | 40     | 42     | 12     | 20  |
| 222.2   | 30     | 40     | 45     | 14     | 16  |
| 222.3   | 40     | 56     | 52     | 16     | 12  |
| 223.1   | 36     | 38     | -      | 10     | 16  |
| 223.2   | 36     | 38     | -      | 10     | 16  |



Rulli guida in gomma NBR SH80  
Rubber NBR SH80 guide rollers

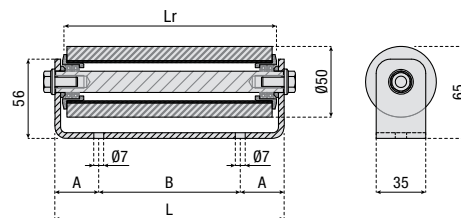

| 00101100 | D (mm) | LR (mm) | L (mm) | H (mm) | B (mm) | I (mm) |   |
|----------|--------|---------|--------|--------|--------|--------|---|
| 225.03   | 50     | 75      | 87     | 65     | 35     | 40     | 8 |
| 225.06   | 50     | 150     | 162    | 65     | 35     | 40     | 4 |
| 225.12   | 50     | 300     | 312    | 65     | 35     | 40     | 8 |

Rulli guida in nylon bianco  
White nylon guide rollers

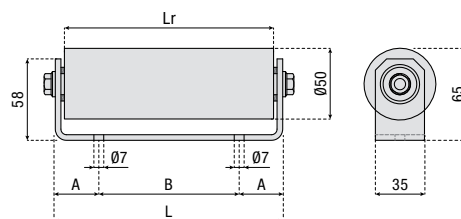

| 00101100 | D (mm) | LR (mm) | L (mm) | H (mm) | B (mm) | A (mm) |   |
|----------|--------|---------|--------|--------|--------|--------|---|
| 226.03   | 50     | 75      | 87     | 65     | 50     | 40     | 8 |
| 226.06   | 50     | 150     | 162    | 65     | 100    | 40     | 4 |
| 226.12   | 50     | 300     | 312    | 65     | 200    | 40     | 8 |

Rulli guida in nylon bianco con piastra  
White nylon guide rollers with plate

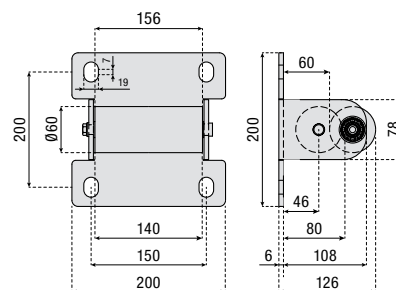

| 00101100 |   |
|----------|---|
| 227.80   | 2 |

Rulli guida in nylon bianco  
White nylon guide rollers

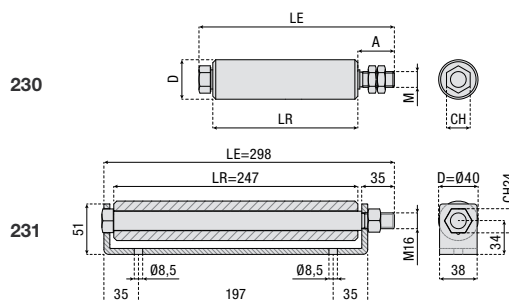

| 00101100 | D (mm) | LE (mm) | LR (mm) | A (mm) | M (mm) | CH (mm) |    |
|----------|--------|---------|---------|--------|--------|---------|----|
| 230.1    | 40     | 198     | 147     | 35     | 16     | 24      | 8  |
| 230.2    | 40     | 298     | 247     | 35     | 16     | 24      | 10 |
| 231.0    | 40     | 298     | 247     | 35     | 16     | 24      | 6  |



# BATTENTI LIMIT SWITCHES

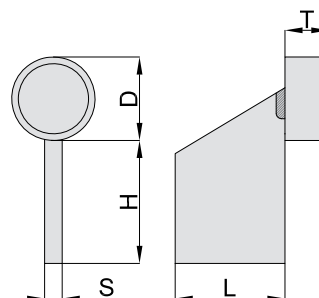

■ Battente fine corsa a saldare  
Limit switch to be welded

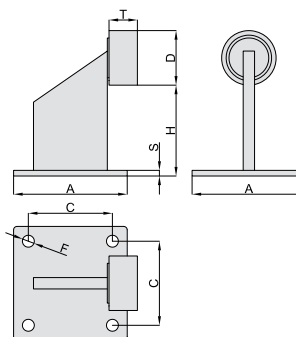

|  | D (mm) | H (mm) | L (mm) | T (mm) | S (mm) |  |
|--|--------|--------|--------|--------|--------|--|
| 241.1  | 38     | 55     | 50     | 20     | 8      | 12   |
| 241.2  | 48     | 75     | 70     | 25     | 10     | 8  |

■ Battente fine corsa con piastra di fissaggio  
Limit switch with fixing plate



|  | A (mm) | S (mm) | C (mm) | F (mm) | D (mm) | H (mm) | T (mm) |  |
|---|--------|--------|--------|--------|--------|--------|--------|---|
| 242.1   | 85     | 5      | 60     | 8,5    | 38     | 60     | 20     | 8   |
| 242.2   | 100    | 5      | 74     | 10,5   | 48     | 80     | 25     | 6   |

■ Battenti fine corsa con piastra di fissaggio sagomata  
Limit switch with contoured fixing plate



243.2

244.2

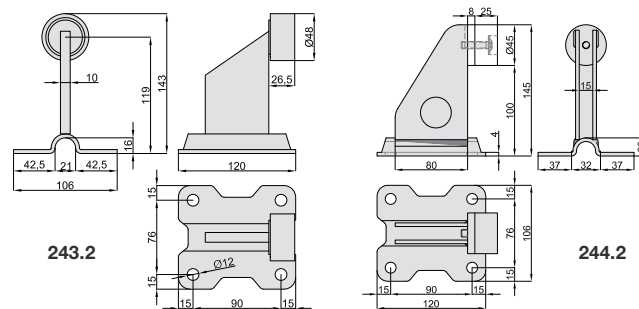

|  |  |
|---|---|
| 243.2   | 8   |
| 244.2   | 6   |

Battente fine corsa con tampone in gomma regolabile  
Limit switch with adjustable rubber pad

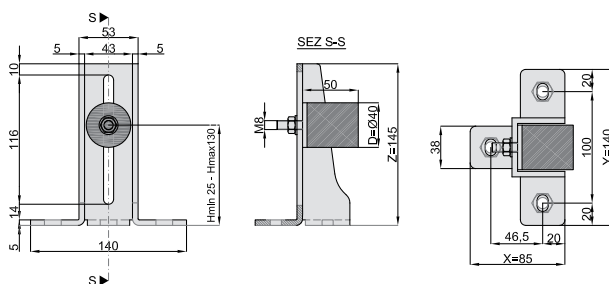

|   |   |
|---|---|
|  |  |
| 244.4   | 4   |

Battente fine corsa ammortizzato con molla - a saldare  
Limit switch with shock absorber spring to be welded

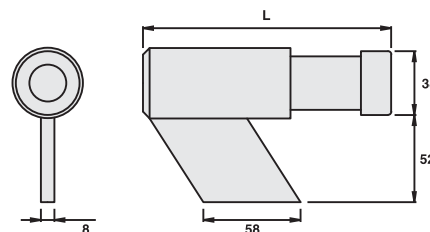

|  |         |   |
|--|---------|---|
|  | L (mm)  |  |
| 245.1  | 150-120 | 4   |

Battente fine corsa ammortizzato con molla e piastra di fissaggio  
Limit switch with shock absorber spring and fixing plate



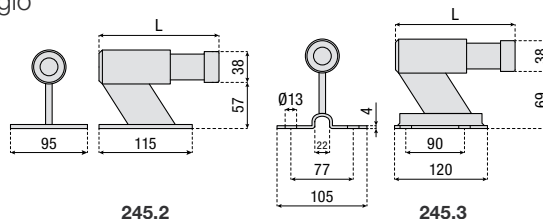

245.2

245.3





245.2

245.3

|  |         |   |
|--|---------|---|
|  | L (mm)  |  |
| 245.2  | 150-120 | 4   |
| 245.3  | 150-120 | 4   |

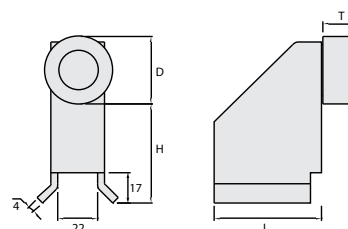

Battente finecorsa a saldare  
Limit stops for sliding gates to be welded

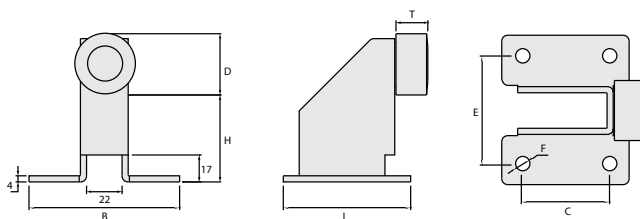

|   |        |        |        |        |   |
|---|--------|--------|--------|--------|---|
|  | D (mm) | H (mm) | L (mm) | T (mm) |  |
| 246.1   | 38     | 55     | 60     | 20     | 8   |
| 246.2   | 43     | 72     | 75     | 26     | 6   |

Battente finecorsa a fissare  
Limit stops for sliding gates to be fixed



|   |        |        |        |        |        |        |        |        |   |
|---|--------|--------|--------|--------|--------|--------|--------|--------|---|
|  | A (mm) | B (mm) | C (mm) | E (mm) | F (mm) | D (mm) | H (mm) | T (mm) |  |
| 247.1   | 80     | 94     | 55     | 68     | 9      | 38     | 55     | 20     | 6   |
| 247.2   | 95     | 107    | 65     | 78     | 11     | 43     | 75     | 26     | 4   |

# INCONTRI FINECORSA LIMIT STOPS

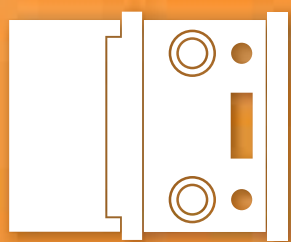

Incontro di sicurezza a saldare  
Safety holder to be welded

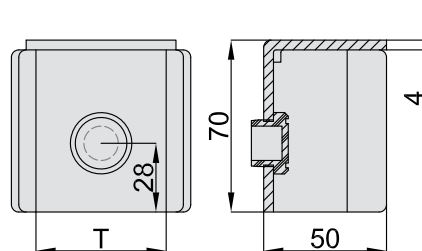

| 00101100 | T (mm) |   |
|----------|--------|---|
| 250.1    | 43     | 6 |
| 250.2    | 53     | 6 |
| 250.3    | 63     | 4 |
| 250.4    | 83     | 4 |

Incontro finecorsa per cancelli scorrevoli  
Limit stop for sliding gates

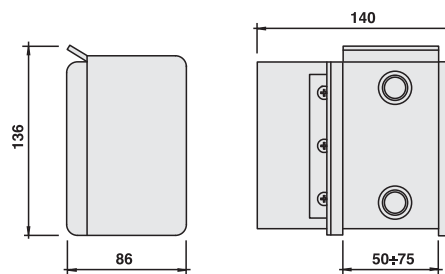

| 00101100 | VERSIONE<br>VERSION |   |
|----------|---------------------|---|
| 251.1    | DX / RIGHT          | 5 |
| 251.2    | SX / LEFT           | 5 |

- con tettuccio di sicurezza contro le effrazioni
- anti-tamper device

Incontro regolabile  
Adjustable gate limit stop

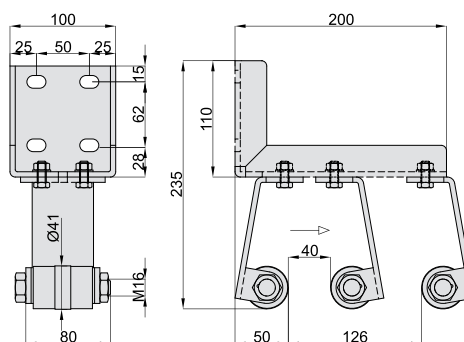

| 00101100 |   |
|----------|---|
| 269.2    | 2 |



BENINCÀ · HOLDING

### BENINCÀ HOLDING SpA

via Capitello, 43

36066 Sandrigo (VI) ITALY

T +39 0444 751030

F +39 0444 759728

[www.benincaholding.com](http://www.benincaholding.com)

### US branch :

**BENJOY AMERICA LLC. dba**



6357 NW 99 AVE

Miami FL 33178

ph. + 1 - 305 - 418 0090

fax + 1 - 305 - 716 9271

[beninca.usa@beninca.com](mailto:beninca.usa@beninca.com)

[www.beninca-usa.com](http://www.beninca-usa.com)

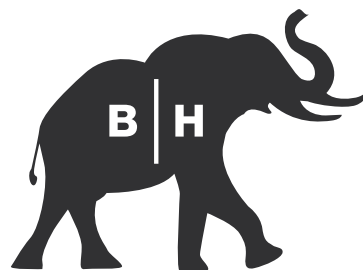

**BENINCÀ HOLDING** oggi è diventata una splendida realtà, un sogno che si è concretizzato per dare forma ad obiettivi di specializzazione da sempre perseguiti.

Una scelta istituzionale per esprimere una mission precisa: offrire soluzioni operando da specialisti nel settore automazione.

L'elefante è il testimone formale che abbiamo scelto per **BENINCÀ HOLDING**, il simbolo che meglio rappresenta la scelta precisa di solidità, affidabilità istituzionale, ma anche intelligenza e dinamismo verso i partners internazionali e verso tutti i clienti.

Today **BENINCÀ HOLDING** has become a splendid reality, a dream that has come true to give shape to aims of specialisation that we have always pursued.

A corporate decision to express a precise mission: offering solutions by acting as specialists in the automation sector.

The elephant is the symbol we have chosen for **BENINCÀ HOLDING**, the image that best represents our precise choice of corporate strength and reliability, but also intelligence and dynamism when interacting with international partners and with all customers.



### AUTOMATISMI BENINCÀ SpA

via Capitello, 45

36066 Sandrigo (VI) ITALY

T +39 0444 751030

F +39 0444 759728

[www.beninca.com](http://www.beninca.com)

[sales@beninca.it](mailto:sales@beninca.it)



### AUTOMATISMI CAB Srl

via della Tecnica, 10 (Z.I.)

36010 Velo D'Astico (VI) ITALY

T +39 0445 741215

F +39 0445 742094

[www.automatismicab.com](http://www.automatismicab.com)

[info@automatismicab.com](mailto:info@automatismicab.com)



### HI MOTIONS Srl

via dell'Industria, 91

36030 Sarcedo (VI) ITALY

T +39 0445 367536

F +39 0445 367520

[www.himotions.com](http://www.himotions.com)

[info@himotions.com](mailto:info@himotions.com)



### RISE Srl

via Maso, 27

36035 Marano V. (VI) ITALY

T +39 0444 751401

[www.riseweb.it](http://www.riseweb.it)

[info@riseweb.it](mailto:info@riseweb.it)



### BYOU

via Capitello, 45

36066 Sandrigo (VI) ITALY

T +39 0444 1510294

F +39 0444 759728

[www.byouweb.com](http://www.byouweb.com)

[info@byouweb.com](mailto:info@byouweb.com)



### MYONE Srl

via T. Edison, 11

30035 Ballò di Mirano (VE) ITALY

T +39 041 412542

F +39 041 412542

[www.myoneautomation.com](http://www.myoneautomation.com)

[info@myoneautomation.com](mailto:info@myoneautomation.com)



## HI-MOTIONS S.r.l.

---

Via dell'Industria, 91 // 36030 Sarcedo (VI) ITALY  
**T** +39 0445 367536 // **F** +39 0445 367520  
**info@himotions.com // www.himotions.com**