

# Land for Sale Wetaskiwin County

Legal Address W5-4-47-1-W

Municipal address: HWY 20 TWP 470 Wetaskiwin County

Nearest town: Winfeild

Size: 53.93 acres

## Features

- Soil: Class 4
- Lease revenue from onsite wells: \$6,100.00 per year
- Fenced Pasture

Taxes (2019): \$47.83

**Price: \$160,000** GST may apply

Call Norman Hill @ (780) 903-6199  
Hill Realty Inc. (780) 449-5622  
#144 363 Sioux Road Sherwood Park

*All information displayed is believed to be accurate but is not guaranteed and should be independently verified. No warranties or representations of any kind are made.*



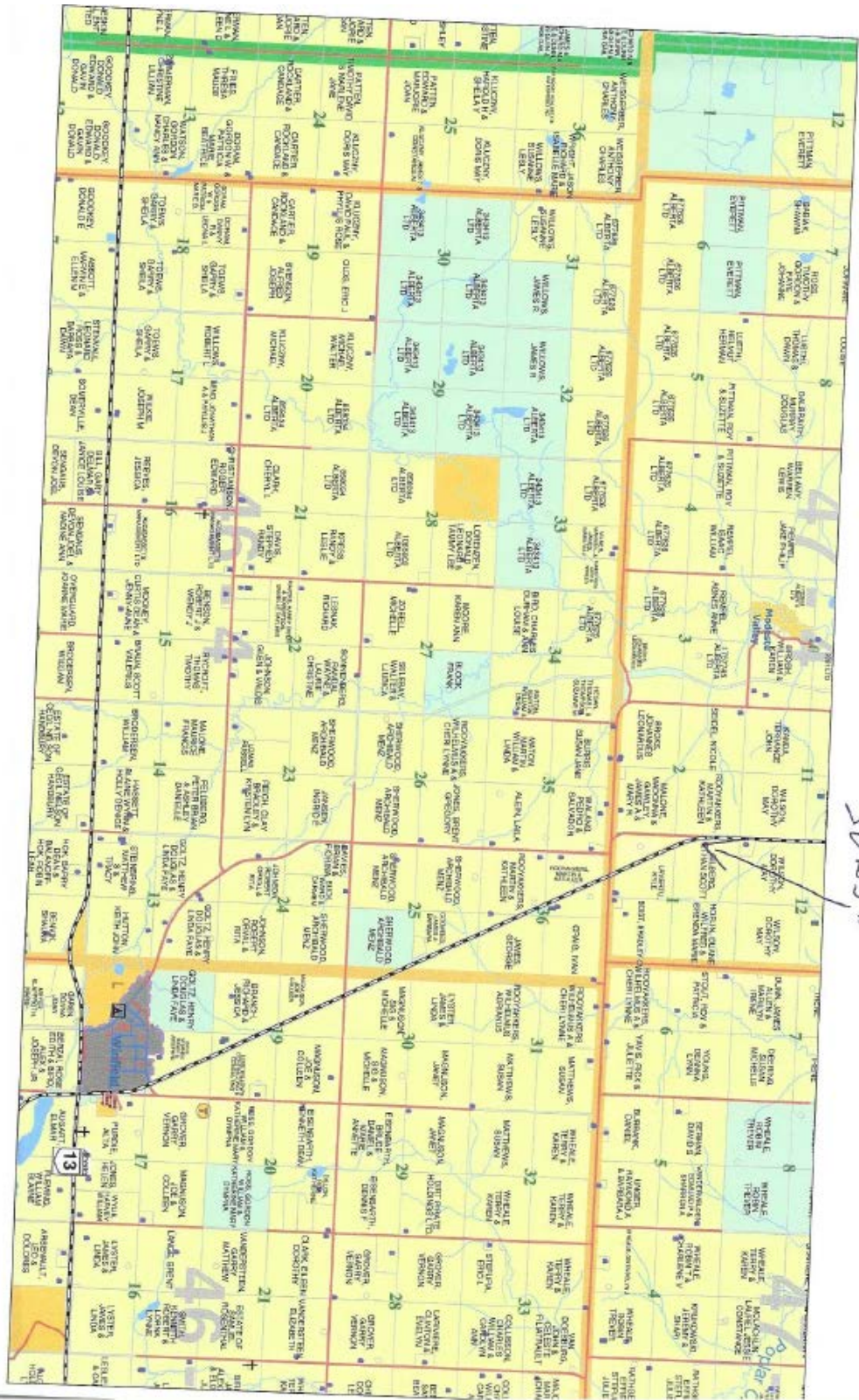

SUBJECT PROPERTY