

VIC JUBA COMMUNITY THEATRE



VENUE TECHNICAL SPECIFICATIONS

Information updated January 2023

VIC JUBA COMMUNITY THEATRE

**Location:**

2602 59 Avenue

Lloydminster, AB Canada

T9V 3N7

Main Phone: (780) 872-7400**Website:** www.vicjubatheatre.ca**Rental info:** rental@vicjubatheatre.ca**Contacts:****General Manager:** Jen McConnell jen@vicjubatheatre.ca**Technical Director:** Andrew Forrester andrew@vicjubatheatre.ca**Box Office / Marketing:** Bridget Walsh box.office@vicjubatheatre.ca

Here at Vic Juba Community Theatre, we acknowledge that the land we gather on is the traditional homeland, hunting, and ceremonial gathering places of the First Nations, Métis and Inuit. The Plains Cree, Woodland Cree, Saulteaux, Blackfoot, Métis, Dene, and Nakota Sioux people have practiced their culture and languages on Treaty 6 and Métis Region 2 territories for generations and were the original caretakers of this land. Many First Nation, Métis and Inuit peoples call this land home today and have done so for millennia. We would like to acknowledge the history we have created together on this land, and to be thankful for the opportunity to walk together side-by-side in friendship, learning from our past, and promoting positive relationships for the past, present and future.

SEATING MAP

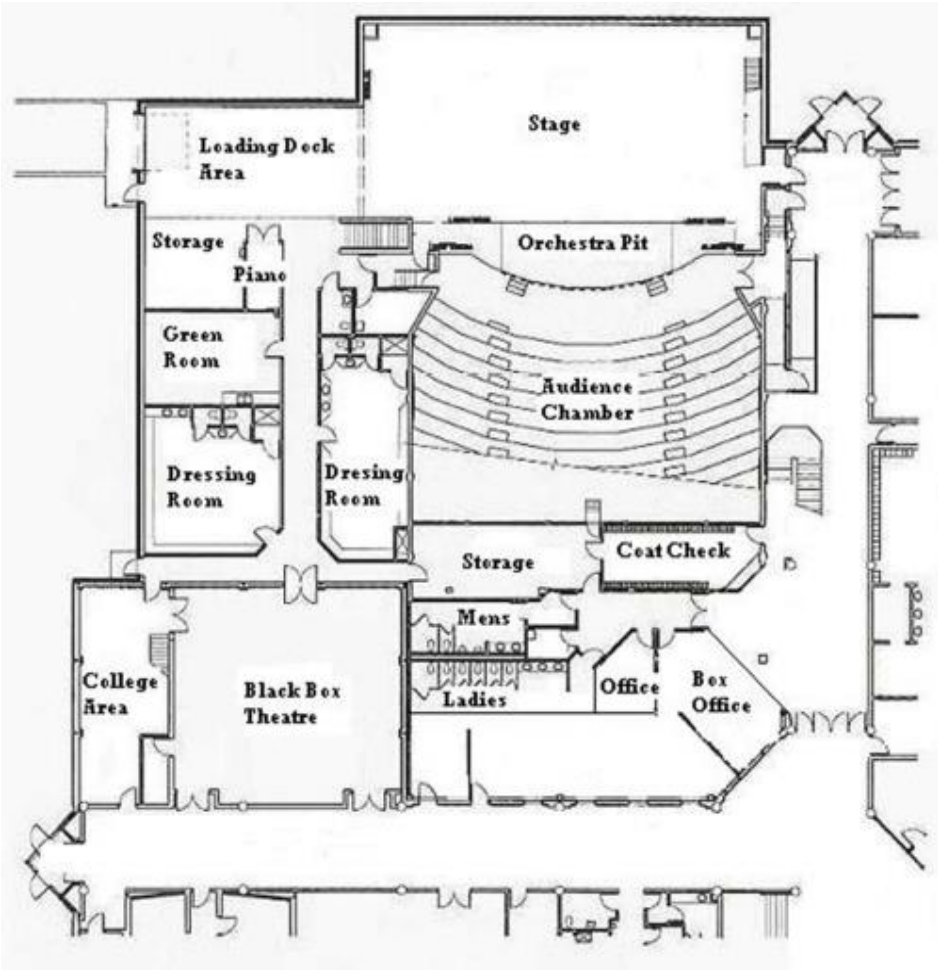
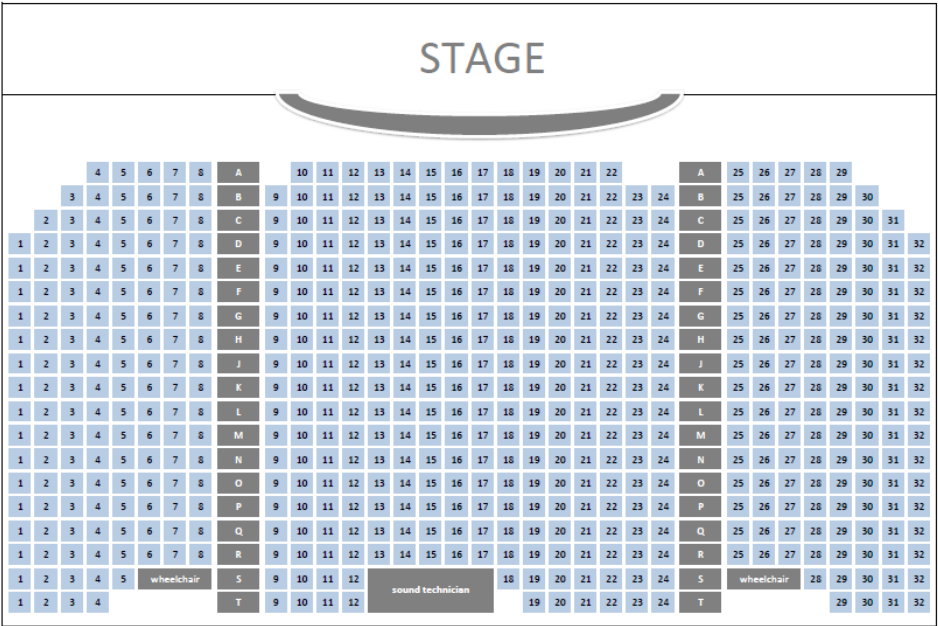

LOADING DOCK



SHORE POWER IS AVAILABLE UPON REQUEST



STAGE



STAGE DATA

Dimensions:

Proscenium Opening (fixed):	55'0" w x 21'10" h
Width (wall to wall):	74'7"
Width (curtain to curtain):	44'
Depth (apron front to wall):	46'10"
Depth (back of apron to ground row):	24'0"
Depth (apron front to ground row):	36'0"
Depth (apron front to black traveler mid-track):	26'0"
Grid Height:	25'0"
Smoke door height:	13'0"
Smoke door width:	18'0"
Loading Area:	19'9" w x 39'10"
Loading Door:	9'10" w x 7'8"h
There is no fly gallery.	

Stage Drapes

The house drape hang can only be altered through prior advancing with our Technical Director.

Main Curtain	1 – Royal blue; operated stage right
Main Drape Border	1 – Royal blue
Traveller	2 – Black; mid-stage or upstage positioning via switch track – 60' X 22'
Borders	2 – Black – 48' X 4'
Legs	8 – Black – 22' X 12'
Cyclorama	1 – 48' X 22'

STAGE LEFT



STAGE RIGHT



Supplementary Equipment (Music)

- 1 Conductor's Music Stand (2'6" x 1'8")
- 1 Conductor's Podium
- 90 Black Band Chairs (Black Music Posture chair w/o padding)
- 70 Music Stands (1'8" x 1'0")
- 20 Music Lights
- 3 Three Step Choral Risers w/ rails, 6' length
- 3 Three Step Choral Risers w/ rails, 4' length

- 1 Band Shell – 14 pieces (rental)
- 1 9' Yamaha Grand Piano (rental, tuning will be scheduled)
- 7 Rolls of Rosco "Adaggio" Black Dance Floor – 42' X 31'
- 1 Upright piano (Yamaha WX7F)

Supplementary Equipment (Stage)

- 1 VJCT Branded Lectern
- 6 4 feet by 8 feet risers (8-inch, 16-inch, 24-inch legs available as well railings and skirt)
- 2 Stairs to accompany risers, suitable for 16 inch and 24-inch heights.
- 4 Stairs to stage - 24" (1 house right, 1 house left, 2 may be used together at center)

Supplementary Equipment (Backline)

- 1 Canwood Mahogany Drum 4pc Drum Set
- 1 Mapex Mars 5 pc Drum Hardware kit
- 1 Sabian B8X 5pc Cymbal Set
- 1 Vintage Fender Twin guitar amplifier
- 1 Traynor 500w Bass Head
- 1 Traynor 2x10 Bass cabinet
- 3 Assorted guitar stands.



AC Power

- 1 150A Service - stage right (loading dock) - 20' travel required from subpanel location to typical stage right touring lighting central location.
- 1 150A Service – upstage centre – 40' to S.L. Monitor Location
- 1 150A Service – in orchestra pit, upstage wall

AUDIO

Main Speaker System

- 12 F730P EAW Cabinet 3-way line array. Flown, 6 per side.
- 4 SB528ZR EAW Cabinet Subwoofer 2 X 18. 2 per side, on Stage.
- 4 EAW UB3521 Front Fills.
- 2 UX 8800 EAW Processor.
- 4 Meyer UPA Powered Speaker.

Monitoring

- 8 EAW SM 200IH Monitors
- 1 Yorkville Sub
- 2 Shure PSM300 In Ear Monitors
- 1 24 Channel Split snake 100 feet

FOH/Monitor Mixing Console

- 1 Allen & Heath DLive C3500 Digital console
- 1 Allen & Heath DLive DMO Mix Rack
- 4 Allen & Heath DX168 Stage box
- 1 Allen & Heath IP8 Remote

- 1 Midas M32 Live Digital Console
- 1 Midas DL32 Stage Box
- 1 Waves Superrack for M32 (by request)
- 1 Yamaha M7CL 48 Digital Console
- 1 QLAB Playback Computer
- 1 Focusrite 8ch Interface (by request)
- 3 Shielded Cat5e Ethercon runs from FOH to stage left.

Microphones & Stands

- 7 Shure Beta 58A
- 7 Shure Beta 57A
- 1 Shure Beta 52A
- 3 Crown PCC 160
- 1 AKG C414B Mic
- 2 Neumann KM184
- 2 Crown CM 31 Choir Mics
- 8 Sennheiser EW500 G4 Wireless Microphone Sets w/MKE1 Lavalier mics.
- 4 Sennheiser SKM500 Handheld transmitters w/ 935 capsules
- 8 K&M round base mic stands with Telescoping Boom
- 12 K&M tripod stands with Telescoping Boom
- 12 K&M tripod mid/short stands with Telescoping Boom
- 4 K&M tabletop stands.
- 2 K&M 26' overhead heavy-duty boom stands (KM 20811)

D.I. Boxes

- 2 Radial PRO AV1
- 6 Radial JDI - Passive DI
- 4 Radial J48 - Active DI
- 1 DI PRO ST1 Cable Factory

Main Control Booth: Located at the rear of the house - fully equipped.

Touring mix location is in the centre of Rows R & S, seats at the rear of the house, directly in front of the Control Booth. Analog I/O (patchbay in Control booth) plus 3 dedicated, shielded Cat5e Ethercon lines run from this position to stage.

LIGHTING



The house lighting hang can only be altered through prior advancing with the Theatre's Technical Director.
Patch and plot available upon request.

Control Console

- 1 ETC IONxe w/ External 2x20 Eos Fader Wing
- 192 ETC Sensor+ dimmers 2.4 KW outlets

Equipment Available

- 12 ETC Lustre 2 LED (FOH)
- 18 Martin MAC250
- 24 ETC Coloursource Pars LED (ON STAGE)
- 12 Strand SL Ellipsoidal 26deg
- 36 ETC Source Four Pars with interchangeable lenses
- 7 ETC Coloursource CYC
- 2 Follow Spots – Lycian 1207 Midgets (575w) – Located on first FOH catwalk.
- 1 Aqua Fog 3300 Dry Ice Machine
- 1 MDG Atmosphere APS Haze machine

Lighting Positions

- 2 FOH Cat Walks (15 feet and 30 feet from proscenium)
- 2 FOH Side Rails (1 HL, 1 HR)
- 1 FOH Rail (back of House)
- 8 Rows of electrics (onstage)

Circuit Positions

- 80 Onstage (in air, 10 banks of 8)
- 52 FOH Cat Walks (26 each)
- 12 FOH Rail (back of house)
- 12 FOH Side Rails (6 each)
- 6 Raised Onstage Walls (2 banks of 3)
- 10 Floor Level Onstage Walls (3 banks of 2)
- 12 Onstage Floor Pockets (4 banks of 3)
- 2 Back of house (1 HL, 1 HR, floor level)
- 4 Orchestra Pit (2 banks of 2)

Communications

- 1 Clear-com Freespeak2 Edge Base station
- 10 Clear-com Freespeak2 Belt packs w/ single muff headsets
- 1 Bogen paging & program sound system.

VIDEO

Panasonic 12,000 Lumen Laser projector

Small screen at proscenium opening.

Large screen in front of cyclorama

HDMI or SDI connections are available throughout the venue.

BACKSTAGE

Dressing Room #1 - Shaw

Accommodates approximately 20 people: 1 shower, 3 sinks, 2 toilets, 2 rolling costume racks.

Dressing Room #2 - Shakespeare

Accommodates approximately 20 people: 1 shower, 3 sinks, 2 toilets, 2 rolling costume racks.

Green Room – W. O. Mitchell

Accommodates approximately 20 people: microwave, bar fridge, television monitor, tables, chairs, couches and dishwasher.

There is a stackable washer and dryer in the Theatre.

STAFFING

- The number of personnel required will be determined by the Technical Director to ensure your event's technical needs are met. Unless otherwise arranged, we will use up to 3 technicians for your event. If you require additional crew (spotlight operators, loaders, extra stagehands, etc.), there will be additional charges applied. If you have questions regarding your technical requirements, please contact our Technical Director.
- Theatre staff are provided a minimum of a 30-minute break within every 5 hours worked, as per Alberta Employment Standards.

USE OF HAZARDOUS MATERIALS

All pyrotechnics require a licensed pyro-technician who must be approved prior to the event by the Technical Director.

Vic Juba Community Theatre does not allow any open flame anywhere on the premises.

Substance Regulations

Government of Canada legislation requires that the use of “controlled” products in our theatres shall comply with the rules under WHMIS (Workplace Hazardous Materials Information System). Controlled products include:

- Compressed Gas
- Flammable and Combustible Material
- Oxidizing Material
- Poisonous and Infectious Material
- Corrosive Material
- Dangerously Reactive Material

WHMIS regulations require that:

- a) Anyone using a controlled product in the workplace must be informed as to its safe storage, handling, use and disposal.
- b) All containers of controlled products must have warning labels attached that meet regulation requirements.
- c) A MSDS (Material Safety Data Sheet) for any controlled product must be available and be maintained in the immediate work area.

Some substances such as explosives, radioactive materials, and tobacco are covered under separate regulations. Smoking in our Theatre, for example, is restricted under our Civic Bylaws to designated areas only.