

HI®

MOTIONS
OPENING SOLUTIONS

MADE IN ITALY



CATALOGO | CATALOGUE

STORIA HISTORY



B E N I N C À · H O L D I N G

HI
MOTIONS
OPENING SOLUTIONS

Il gruppo **BENINCA' HOLDING** in più di 30 anni ha fatto della specializzazione e della qualità il proprio punto di forza diventando in pochi anni uno dei principali player nel mercato internazionale dell'automazione.

HI MOTIONS è l'azienda del gruppo che porta con sé tutto il know how **BENINCÀ** con in più un forte orientamento al mercato e al cliente, principale interlocutore di tutte le scelte.

Opening solutions è il pay off che sintetizza la mission dell'azienda: offrire soluzioni per tutti i tipi di chiusure garantendo affidabilità, ma soprattutto flessibilità.

• • • • • • • •

In more than 30 years, the specialization and the quality have become the strong point of the **BENINCÀ HOLDING**: this group is now one of the biggest player in the international automation market.

HI MOTIONS is the company of the group with all the **BENINCÀ**'s know how with , in addition, a strong focus on the market and on the customer, which is the main figure in all its choices.

The company's pay off "opening solutions" says it all about its mission: offer solutions for all professional locking systems, with quality and, most of all, with flexibility.



MADE IN ITALY

HI MOTIONS da sempre considera la qualità e l'affidabilità del prodotto elementi essenziali per garantire il massimo servizio ai propri clienti. Per questo nel proprio processo produttivo ha fatto delle scelte precise in termini di qualità. Tutti i prodotti sono progettati e realizzati interamente in Italia, questo consente all'azienda di garantire al cliente un prodotto in grado di rispondere alle precise esigenze e richieste del mercato in termini di affidabilità e professionalità. Il made in Italy per HI MOTIONS dunque è non solo un elemento distintivo, ma una mission che perseguiamo ogni giorno anche attraverso il servizio offerto al cliente nella progettazione di servizi e sistemi personalizzati.

HI MOTIONS has always regarded product quality and reliability as essential elements in guaranteeing top-level service for its customers. For this reason, the company has implemented some specific adjustments to its production process in order to enhance quality. All the products are designed and manufactured entirely in Italy, therefore the company is able to guarantee customers a product capable of satisfying specific requirements and market requests in terms of reliability and professionalism. For HI MOTIONS, therefore, "made in Italy" quality is not only a distinctive element, but a mission we pursue day after day, also through the design of customised services and systems offered to customers.

CANCELLI AD ANTA SWING GATES



CARDINI SUPERIORI
UPPER
HINGES

66

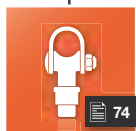

CARDINI A COLLARE
PLAIN ROUND
HINGES

74



TRONCHETTI
STUB PIPES

76



PUNTALI
SPEARS

77



COPRICOLONNA
SQUARE
CAPS

80

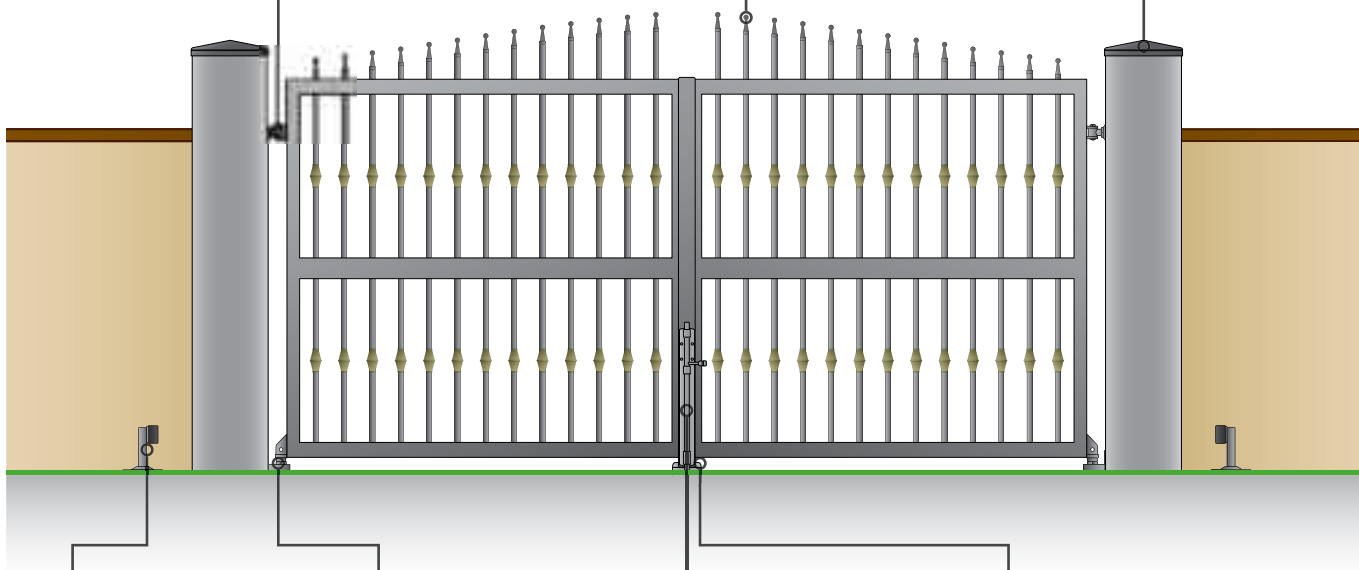

78



64

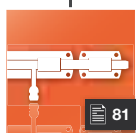

81



78



47

BATTENTI
FINECORSA
DOOR STOPS



72

CARDINI CON
CUSCINETTO
HINGES WITH
BEARING

CATENACCI
BOLTS

BATTENTI
FINECORSA
DOOR STOPS

Cardine inferiore regolabile con piastra orizzontale di fissaggio
Adjustable lower hinge with horizontal fixing plate

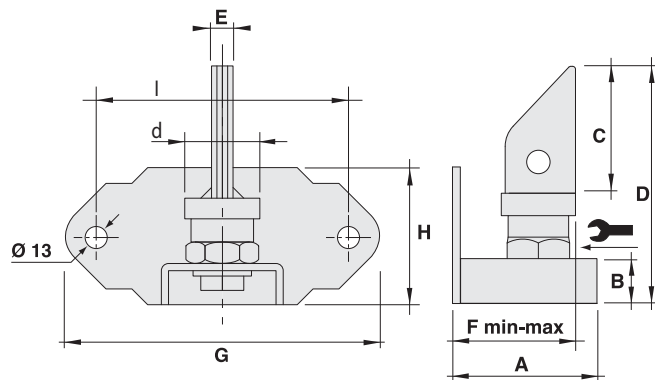

	A (mm)	B (mm)	C (mm)	D (mm)	d (mm)	E (mm)	F _{MIN-MAX} (mm)	G (mm)	H (mm)	I (mm)		
406.1	75	22	65	124	38	12	55-75	156	70	128	32	6
406.2	85	32	80	158	50	18	70-85	170	80	130	41	4

Cardine inferiore regolabile a saldare
Adjustable lower hinge to be welded

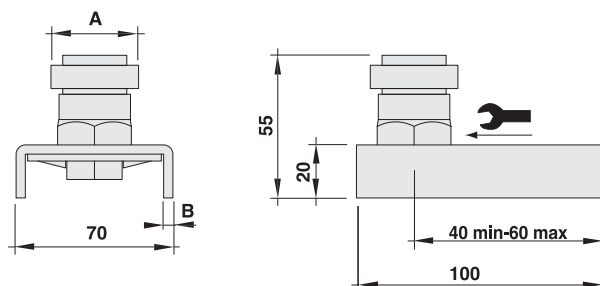

	A (mm)	B (mm)		
409.1	30	3	32	12
409.2	35	4	32	12
409.3	40	5	32	12
409.4	50	6	41	4

Cardine inferiore regolabile con piastrina di fissaggio
Adjustable lower hinge with fixing plate

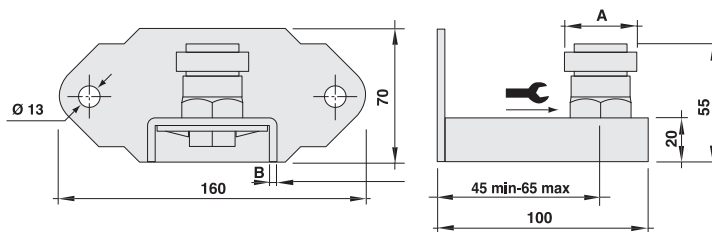

	A (mm)	B (mm)		
410.1	30	3	32	6
410.2	35	4	32	6
410.3	40	5	32	6
410.4	50	6	41	4

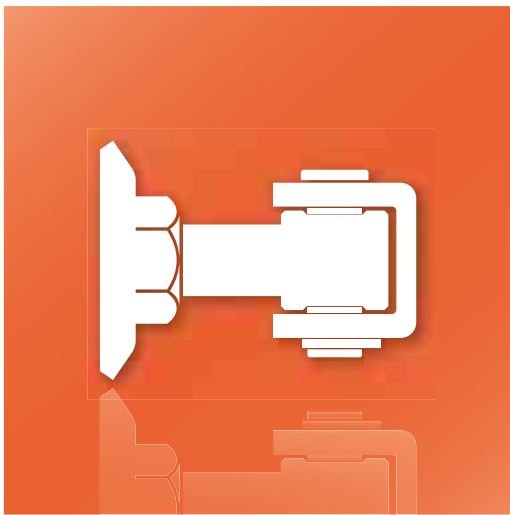

CARDINI SUPERIORI UPPER HINGES

Cardini superiori regolabili con piastre di fissaggio - INOX
Adjustable upper hinge with fixing plate - Stainless Steel

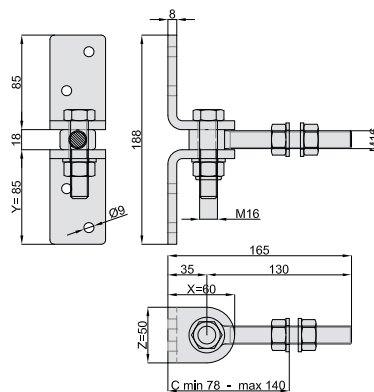

00101100	X (mm)	Y (mm)	Z (mm)	C (mm)	BULLONE BOLT	
415.16	60	85	50	78-140	M16 x 130	4

Cardini superiori regolabili con cavallotto e piastra di fissaggio a 2 fori
Adjustable upper hinges with bracket and fixing plate with 2 holes

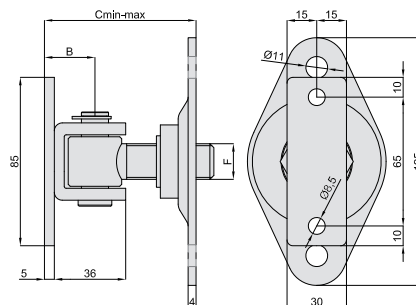

00101100	F (mm)	C _{MIN-MAX} (mm)	B (mm)	
417.16	M16	60-80	25,5	8
417.18	M18	60-85	25,5	8
417.20	M20	60-90	25,5	8

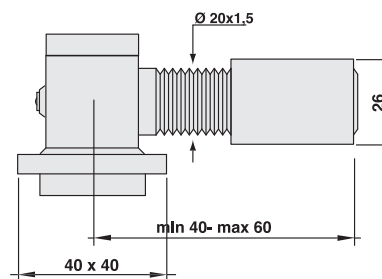

Cardine superiore con manicotto a saldare
Adjustable upper hinges with fixing bracket



00101100	
420.0	12

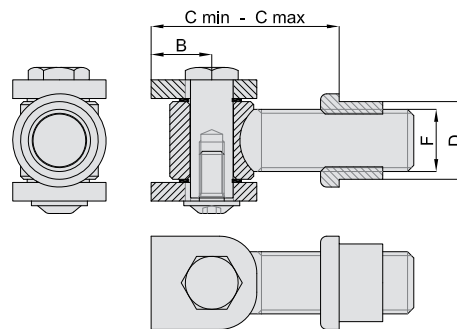

Cardine superiore con piastrine a saldare
Upper hinge with plate to be welded



	F (mm)	D (mm)	C _{MIN-MAX} (mm)	B (mm)	
421.1	M16	21	42-63	19,5	12
421.2	M18	23	42-68	19,5	12
421.3	M20	25	42-70	19,5	12
421.4	M22	28	50-78	22	8
421.5	M24	30,5	50-78	22	8
421.6	M27	35	55-85	24,5	6

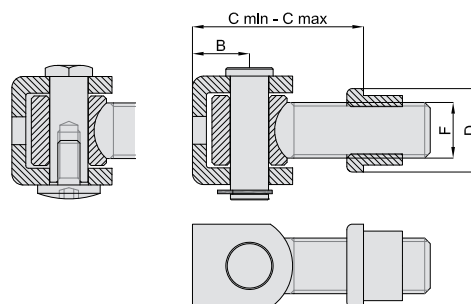

Cardine superiore con cavallotto a saldare
Upper hinge with bracket to be welded

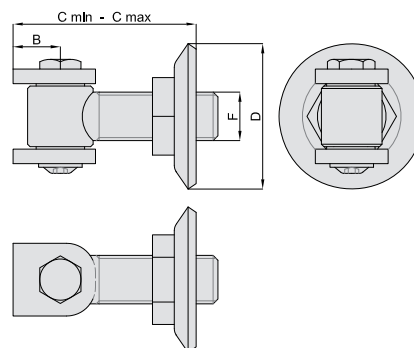

	SEEGER RING	VITE SCREW	F (mm)	D (mm)	C _{MIN-MAX} (mm)	B (mm)	
422.1	422.1F	M16	21	43-63	20,5	12	
422.2	422.2F	M18	23	43-68	20,5	12	
422.3	422.3F	M20	25	43-73	20,5	12	
422.4	422.4F	M22	28	55-82	27,5	8	
422.5	422.5F	M24	30,5	55-82	27,5	8	
422.6	422.6F	M27	35	60-92	31	6	

Cardini superiori regolabili con piastrine e rondella a saldare
Adjustable upper hinges with plate and washer to be welded



	F (mm)	D (mm)	C _{MIN-MAX} (mm)	B (mm)	
423.1	M16	60	55-75	19,5	12
423.2	M18	60	55-80	19,5	12
423.3	M20	60	55-85	19,5	12
423.4	M22	42	62-92	22	8
423.5	M24	53	62-97	22	8
423.6	M27	53	62-102	24,5	6

Cardini superiori regolabili con cavallotto e rondella a saldare
Adjustable upper hinges with bracket and washer to be welded

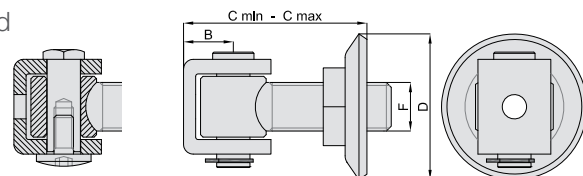

SEEGER SEEGER RING	VITE SCREW	F (mm)	D (mm)	C _{MIN-MAX} (mm)	B (mm)	
424.1	424.1F	M16	60	55-75	20,5	12
424.2	424.2F	M18	60	55-80	20,5	12
424.3	424.3F	M20	60	60-85	20,5	12
424.4	424.4F	M22	42	70-100	27,5	6
424.5	424.5F	M24	53	70-105	27,5	6
424.6	424.6F	M27	53	78-110	31	4

Cardini superiori regolabili con piastrine e piastra di fissaggio a 2 fori
Adjustable upper hinges with plate and fixing plate with 2 holes

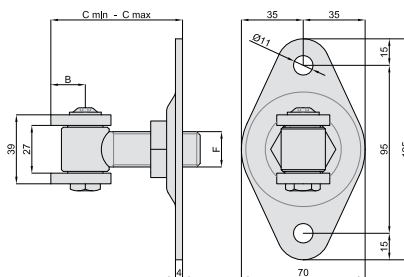

	F (mm)	C _{MIN-MAX} (mm)	B (mm)	
425.1	M16	55-75	19,5	8
425.2	M18	55-80	19,5	8
425.3	M20	55-85	19,5	8

Cardini superiori regolabili con cavallotto e piastra di fissaggio a 2 fori
Adjustable upper hinges with bracket and fixing plate with 2 holes

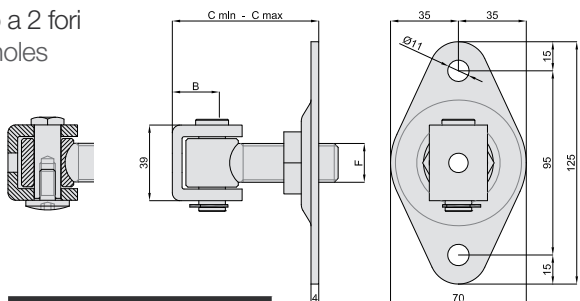

SEEGER SEEGER RING	VITE SCREW	F (mm)	C _{MIN-MAX} (mm)	B (mm)	
426.1	426.1F	M16	55-75	20,5	8
426.2	426.2F	M18	55-80	20,5	8
426.3	426.3F	M20	55-85	20,5	8

Cardini superiori regolabili con piastrina e piastre di fissaggio e 4 fori
Adjustable upper hinges with plate and fixing plates with 4 holes

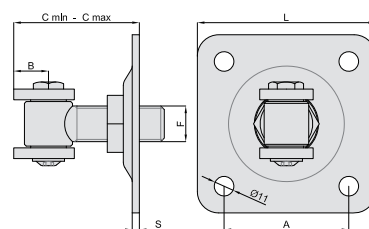

	F (mm)	C _{MIN-MAX} (mm)	B (mm)	L (mm)	A (mm)	S (mm)	
427.1	M16	55-75	19,5	100	67	4	8
427.2	M18	55-80	19,5	100	67	4	8
427.3	M20	55-85	19,5	100	67	4	8
427.4	M22	65-95	27,5	120	90	5	6
427.5	M24	65-100	27,5	120	90	5	6
427.6	M27	75-105	31	120	90	5	4

Cardini superiori regolabili con cavallotto e piastre di fissaggio e 4 fori
Adjustable upper hinges with bracket and fixing plates with 4 holes

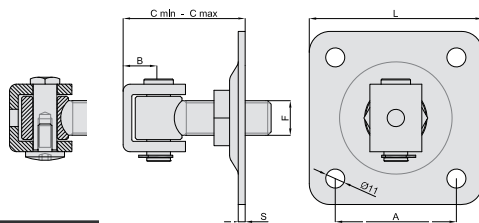

SEEGER SEEGER RING	VITE SCREW	F (mm)	C MIN-MAX (mm)	B (mm)	L (mm)	A (mm)	S (mm)	
428.1	428.1F	M16	55-75	20,5	100	67	4	8
428.2	428.2F	M18	55-80	20,5	100	67	4	8
428.3	428.3F	M20	55-85	20,5	100	67	4	8
428.4	428.4F	M22	70-100	27,5	120	90	5	6
428.5	428.5F	M24	70-105	27,5	120	90	5	6
428.6	428.6F	M27	80-100	31	120	90	5	4

Cardine superiore con 2 cuscinetti e boccola regolabile
Upper hinges with double bearing and adjustable device

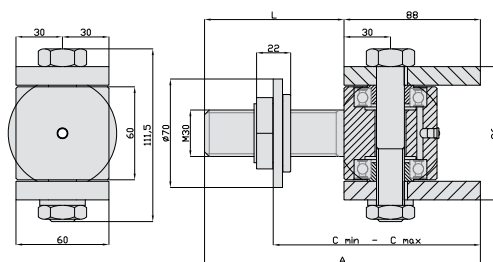

	M (mm)	L (mm)	A (mm)	C (mm)	
429.30	M30	90	178	132-160	2
429.30B	M30	150	238	132-220	2

Cardini superiori con piastrine e manicotto a cementare
Upper hinges with fixing plates and socket joint to be cemented

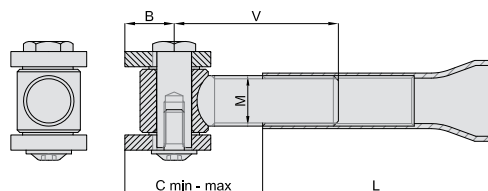

	M (mm)	C MIN-MAX (mm)	B (mm)	L (mm)	V (mm)	
438.2	M18	38-60	19,5	75	60	10
438.3	M20	38-65	19,5	90	65	10
438.5	M24	42-75	22	100	75	8

Cardini superiori con cavallotto e manicotto a cementare
Upper hinges with bracket and joint to be cemented

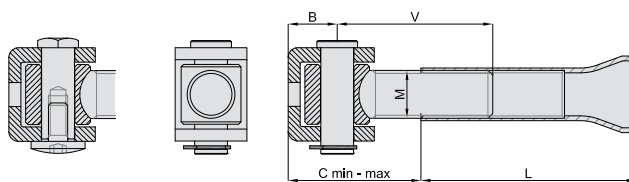

SEEGER SEEGER RING	VITE SCREW	M (mm)	C MIN-MAX (mm)	B (mm)	L (mm)	V (mm)	
439.2	439.2F	M18	40-62	20,5	75	60	10
439.3	439.3F	M20	40-67	20,5	90	65	10
439.5	439.5F	M24	50-80	27,5	100	75	8

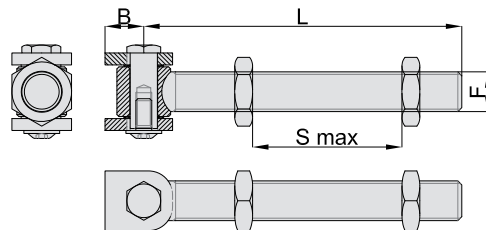

Cardine a vite lunga con piastrina a saldare
Long screw hinge with plate to be welded



	F (mm)	B (mm)	L (mm)	S _{MAX} (mm)	
440.1	M20	19,5	160	125	10
440.2	M24	22	180	140	10

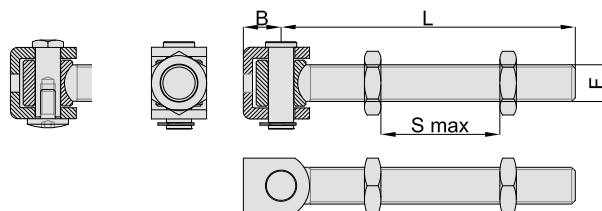

Cardine a vite lunga con cavalletto
Long screw hinge with bracket



	SEEGER SEEGER RING	VITE SCREW	F (mm)	B (mm)	L (mm)	S _{MAX} (mm)	
441.1	441.1F	M20	20,5	160	125	10	
441.2	441.2F	M24	24	180	140	10	

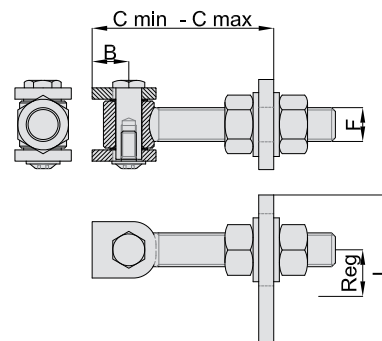

Cardine a doppia regolazione con piastrina a saldare
Hinge with double adjustable device and plate to be welded

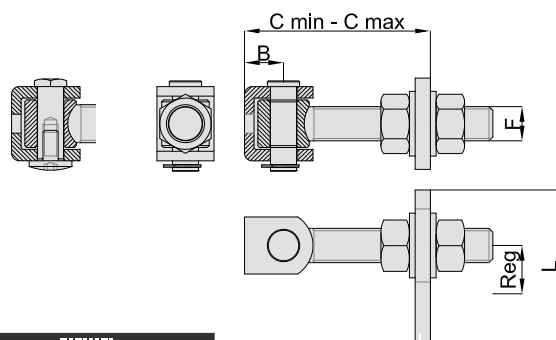

	F (mm)	B (mm)	C _{MIN-MAX} (mm)	Reg.	L (mm)	
442.1	M18	19,5	56-115	20	80	6
442.2	M20	22	65-140	22	105	6

Cardine a doppia regolazione con cavalletto
Hinge with double adjustable device and bracket



	SEEGER SEEGER RING	VITE SCREW	F (mm)	B (mm)	C _{MIN-MAX} (mm)	Reg.	L (mm)	
443.1	443.1F	M18	20,5	56-116	20	80	6	
443.2	443.2F	M22	24	65-140	22	105	6	

Boccola
Bushing

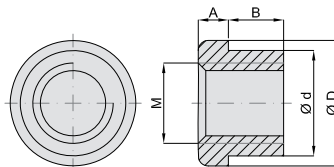

Barcode	F	d (mm)	D (mm)	A (mm)	B (mm)
AN30040	M16	21	25	6	11
AN30050	M18	23	28	6	12
AN30060	M20	25	30	6	14
AN30070	M22	28	34	7	15
AN30080	M24	30,5	36	6	19
AN30090	M27	35	40	8	19

Boccola regolabile
Adjustable bushing

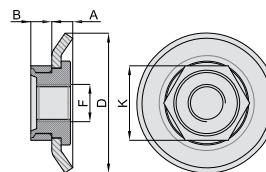

Barcode	F	D (mm)	K (mm)	A (mm)	B (mm)	Box
AN02031	M16	60	32	9	9	10
AN02041	M18	60	32	9	9	10
AN02051	M20	60	32	9	9	10

Boccola regolabile
Adjustable bushing

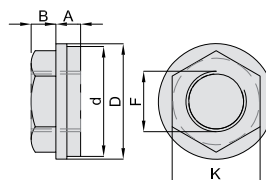

Barcode	F	D (mm)	K (mm)	A (mm)	B (mm)	d (mm)	Box
AN02061	M22	42	32	9	9	40	10
AN02071	M24	53	41	11,5	11,5	40	10
AN02081	M27	53	41	11,5	11,5	40	10

Piastra regolabile a 2 fori
Adjustable plate with 2 holes

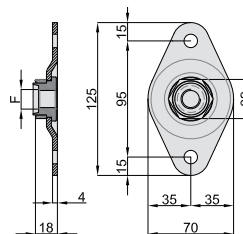

Barcode	F	Box
AN00101	M16	10
AN00111	M18	10
AN00121	M20	10

Piastra regolabile a 4 fori
Adjustable plate with 4 holes

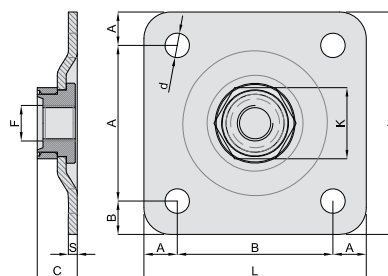

Barcode	F	L (mm)	A (mm)	B (mm)	C (mm)	d (mm)	K (mm)	S (mm)	Box
AN00131	M16	100	15	70	18	11	32	4	10
AN00141	M18	100	15	70	18	11	32	4	10
AN00151	M20	100	15	70	18	11	32	4	10
AN00161	M22	120	15	90	21	11	41	5	10
AN00171	M24	120	15	90	21	11	41	5	10
AN00181	M27	120	15	90	21	11	41	5	10



CARDINI CON CUSCINETTO HINGES WITH BEARING

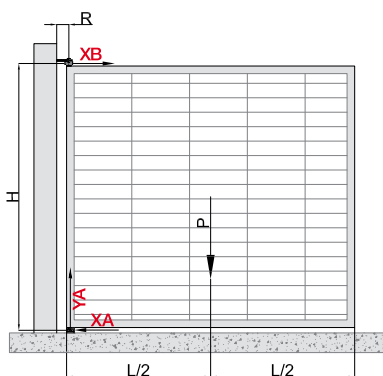

$$XB = \frac{P}{2} * \frac{L}{H}$$

$$XB < XB_{MAX}$$

$$YA = P$$

$$YA < YA_{MAX}$$

P: peso anta / leaf weight

L: larghezza anta / leaf length

H: altezza anta / leaf height

esempio / example:

P= 250 kg | L= 3 m | H= 2 m

$$XB = \frac{250}{2} * \frac{3}{2} = 187,5$$

OK 187,5 (XB) < 225 (XB_{MAX} of 450.2)

NO! 187,5 (XB) > 170 (XB_{MAX} of 450.1)

OK 250 (YA) < 450 (YA_{MAX} of 455.2)

NO! 250 (YA) > 200 (YA_{MAX} of 455.1)

Cardine regolabile con cuscinetto
Adjustable hinge with bearing

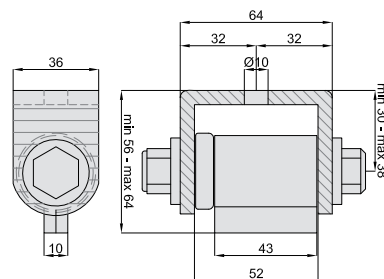

444.0



8

Cardine superiore con cuscinetto e staffa a saldare
Upper hinge with bearing and bracket to be welded

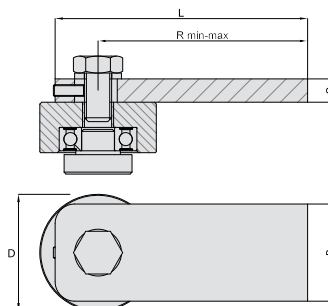

	D (mm)	R _{MIN-MAX} (mm)	L (mm)	P (mm)	S (mm)	XB _{MAX}	
450.1	45	30-55	70	40	10	170 kg	10
450.2	50	75-85	100	40	10	225 kg	10
<i>new</i> 450.22	PRESTO DISPONIBILI VERSIONI CON DOPPIA VITE / VERSIONS WITH TWIN-SCREW WILL BE AVAILABLE SHORTLY					300 kg	10
450.3	60	103-113	130	50	12	300 kg	6
450.4	70	103-113	130	50	12	320 kg	6
<i>new</i> 450.42	PRESTO DISPONIBILI VERSIONI CON DOPPIA VITE / VERSIONS WITH TWIN-SCREW WILL BE AVAILABLE SHORTLY					500 kg	6

Cardine superiore con cuscinetto e staffa a fissare
Upper hinge with bearing and bracket to be fixed

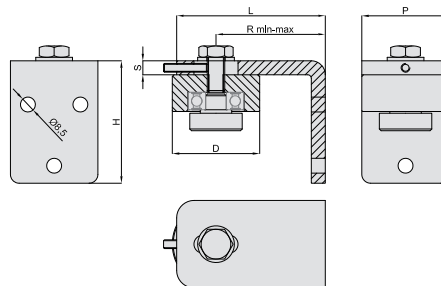

	D (mm)	R _{MIN-MAX} (mm)	L (mm)	P (mm)	H (mm)	S (mm)	XB _{MAX}	
451.2	50	55-70	100	40	70	10	225 kg	10
<i>new</i> 451.22	PRESTO DISPONIBILI VERSIONI CON DOPPIA VITE / VERSIONS WITH TWIN-SCREW WILL BE AVAILABLE SHORTLY						300 kg	10
451.4	70	103-113	130	50	80	12	320 kg	6
<i>new</i> 451.42	PRESTO DISPONIBILI VERSIONI CON DOPPIA VITE / VERSIONS WITH TWIN-SCREW WILL BE AVAILABLE SHORTLY						500 kg	6

Cardine inferiore a saldare con cuscinetto
Lower hinge to be welded with bearing

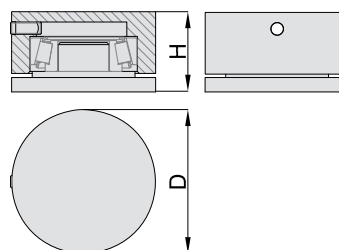

	D (mm)	H (mm)	YA _{MAX}	CARICO STATICO LOAD STATIC	
455.1	45	35	200 kg	800 kg	10
455.2	50	35	450 kg	800 kg	10
455.3	60	35	600 kg	1200 kg	6
455.4	70	35	800 kg	1800 kg	6

Cardine a vite lunga con piastrina a saldare
Long screw hinge with plate to be welded

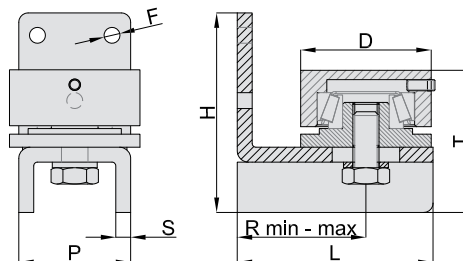

	D (mm)	R _{MIN-MAX} (mm)	L (mm)	P (mm)	H (mm)	F (mm)	S (mm)	T (mm)	YA _{MAX}	CARICO STATICO LOAD STATIC	
456.2	50	55-70	85	50	94	8,5	6	63	450 kg	800 kg	10
456.4	70	58-80	100	60	107	8,5	8	66	800 kg	1800 kg	6

Cardine con fermi meccanici
Hinge with mechanical locking devices

new

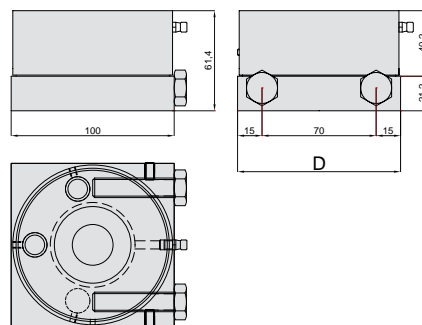



	D (mm)	YA _{MAX}	CARICO STATICO LOAD STATIC	
460.4	80	800 kg	1800 kg	2
460.5	100	1000 kg	3000 kg	2



CARDINI A COLLARE PLAIN ROUND HINGES

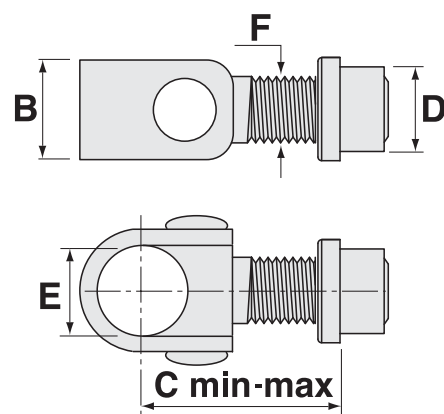

Cardine a collare liscio con boccola a saldare
Plain round hinges with bush to be welded



	F (mm)	D (mm)	C _{MIN-MAX} (mm)	B (mm)	E (mm)	
471.18	M18	23	55-100	30	30	6
471.20	M20	25	55-100	30	30	6
471.22	M22	28	55-100	40	35	6
471.24	M24	30,5	55-100	40	35	6
471.27	M27	35	55-100	40	40	6

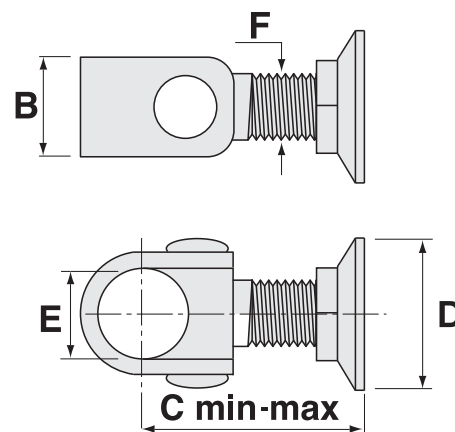

Cardine a collare liscio con boccola regolabile
Plain round hinges with adjustable bush



	F (mm)	D (mm)	C _{MIN-MAX} (mm)	B (mm)	E (mm)	
472.18	M18	50	55-100	30	30	6
472.20	M20	50	55-100	30	30	6
472.22	M22	65	55-100	40	35	6
472.24	M24	65	55-100	40	35	6
472.27	M27	65	55-100	40	40	6

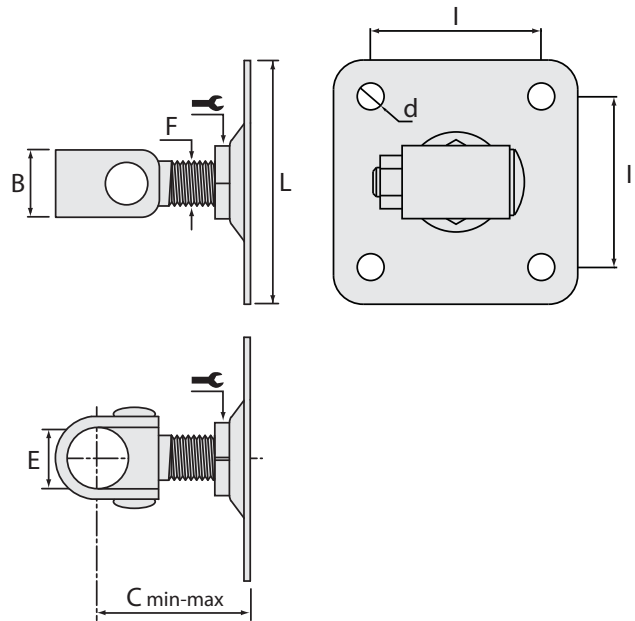

Cardine a collare liscio con piastra di fissaggio 4 fori
Plain round hinges with fixing plate 4 holes

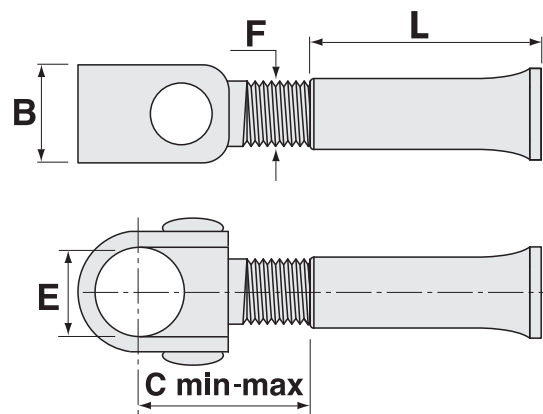

	F (mm)	L (mm)	C ^{MIN-MAX} (mm)	B (mm)	d (mm)	E (mm)	I (mm)	
473.18	M18	100	55-100	30	11	30	70	6
473.20	M20	100	55-100	30	11	30	70	4
473.22	M22	120	55-100	40	11	35	90	4
473.24	M24	120	55-100	40	11	35	90	4
473.27	M27	120	55-100	40	11	40	90	4

Cardine a collare liscio con manicotto a cementare
Plain round hinges with socket joint to be cemented





	F (mm)	L (mm)	C ^{MIN-MAX} (mm)	B (mm)	E (mm)	
474.18	M18	75	55-100	30	30	6
474.20	M20	90	55-100	30	30	6
474.24	M24	100	55-100	40	35	4



TRONCHETTI STUB PIPES

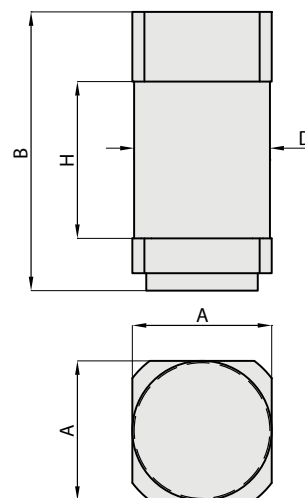

Tronchetto di collegamento per cardini a collare
Stub pipe for round hinges

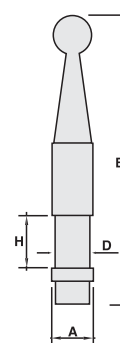

	A (mm)	B (mm)	D (mm)	H (mm)	
493.1	30	80	29	45	6
493.2	35	80	29	45	4
493.3	40	80	29	45	12
493.4	35	80	34	45	12
493.5	40	80	34	45	12
493.6	50	80	34	45	4
493.7	50	80	39	45	4
493.8	40	80	39	45	12

Tronchetto con puntale per cardini a collare
Stub pipe with spears for round hinges



	A (mm)	B (mm)	D (mm)	H (mm)	
494.3	40	250	30	45	6
494.5	40	240	35	45	6

PUNTALI SPEARS

■ Puntale
Spear

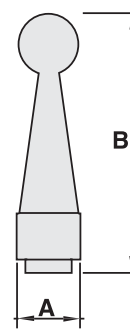

 00101100	A (mm)	B (mm)	
495.3	40	140	6





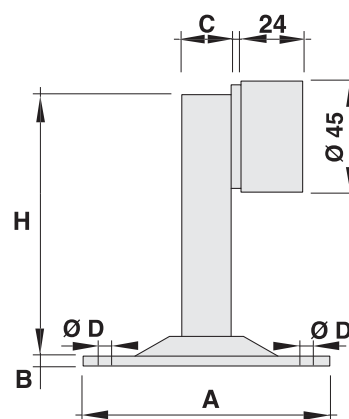

BATTENTI FINECORSA DOOR STOPS

Kit battente di apertura per cancelli ad ante
Door stop kit for swing gates



	A (mm)	B (mm)	C (mm)	FORI Ø D HOLES Ø D	H (mm)	
526.1	100 x 100	4	20 x 20	10	105	2
526.2	120 x 120	5	30 x 30	13	115	2

Battente a cementare per cancelli ad ante
Stops to be cemented for swing gates

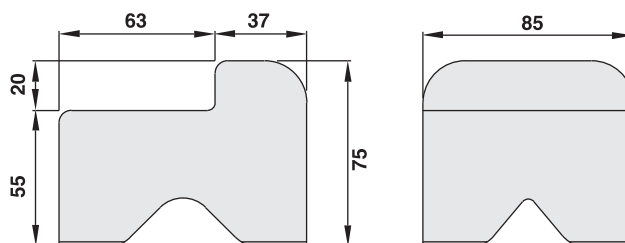

	
530.0	6

Battenti in ghisa con fori di fissaggio per cancelli ad ante
Cast iron stops with fixing holes for swing gates

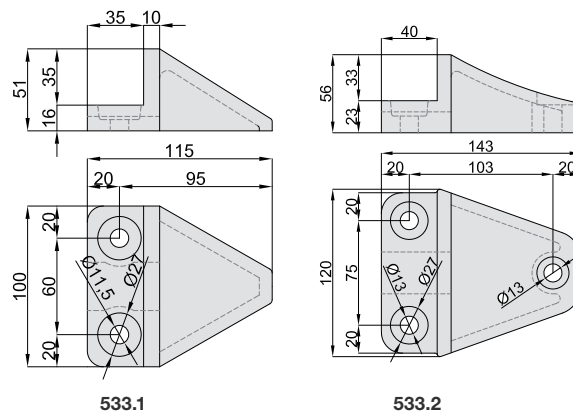

533.1

533.2

533.1	4
533.2	2

Battente a fissare per cancelli ad ante
Limit stop to be fixed for swing gates

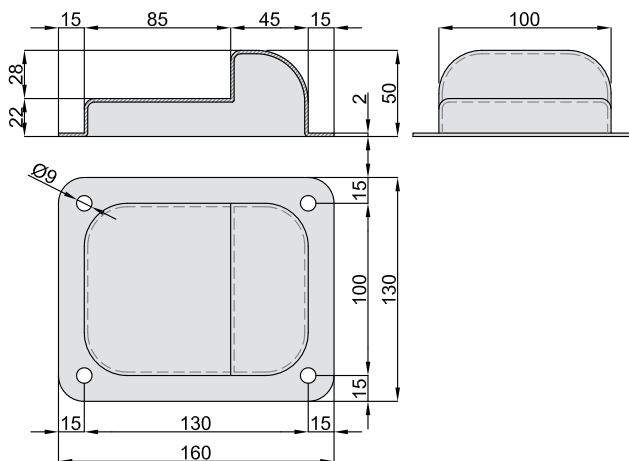

535.0

4

Battente alto con piastrina di fissaggio per cancelli ad ante
Upper limit stop with fixing plate for swing gates

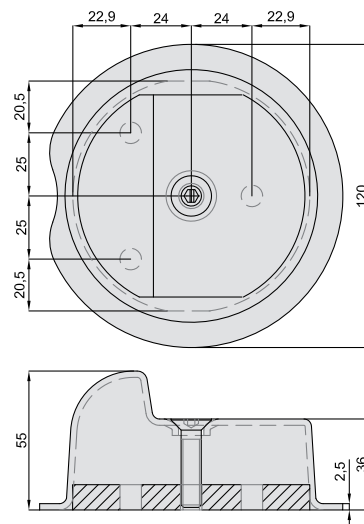

536.0

2



COPRICOLONNA SQUARE CAPS

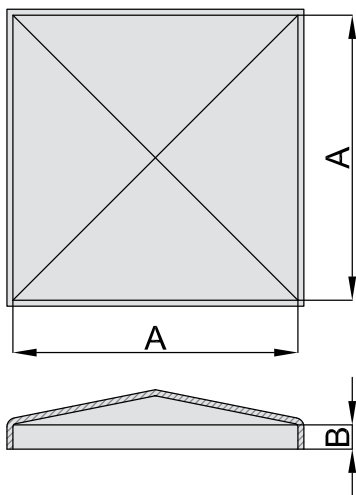

Copricolonna quadrato con bordo
Square cap with flange

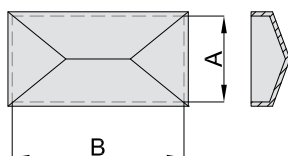

	A (misura interna) A (internal size)	B (mm)	FINITURA FINISH	
550.30	30 x 30	9	ZINCATA / GALVANIZED	100
550.35	35 x 35	10	ZINCATA / GALVANIZED	100
550.40	40 x 40	10	ZINCATA / GALVANIZED	100
550.50	50 x 50	10	ZINCATA / GALVANIZED	60
550.60	60 x 60	10	ZINCATA / GALVANIZED	50
550.80	80 x 80	10	ZINCATA / GALVANIZED	50
550.100	100 x 100	10	ZINCATA / GALVANIZED	50
550.120	120 x 120	10	ZINCATA / GALVANIZED	30
550.150	150 x 150	10	ZINCATA / GALVANIZED	20
550.200	200 x 200	10	ZINCATA / GALVANIZED	10
551.30	30 x 30	9	GREZZO / RAW	100
551.35	35 x 35	10	GREZZO / RAW	100
551.40	40 x 40	9	GREZZO / RAW	100
551.50	50 x 50	10	GREZZO / RAW	60
551.60	60 x 60	10	GREZZO / RAW	50
551.80	80 x 80	10	GREZZO / RAW	50
551.100	100 x 100	10	GREZZO / RAW	50
551.120	120 x 120	10	GREZZO / RAW	30
551.150	150 x 150	10	GREZZO / RAW	20
551.200	200 x 200	10	GREZZO / RAW	10

Copricolonna rettangolare con bordo
Rectangular cap with flange



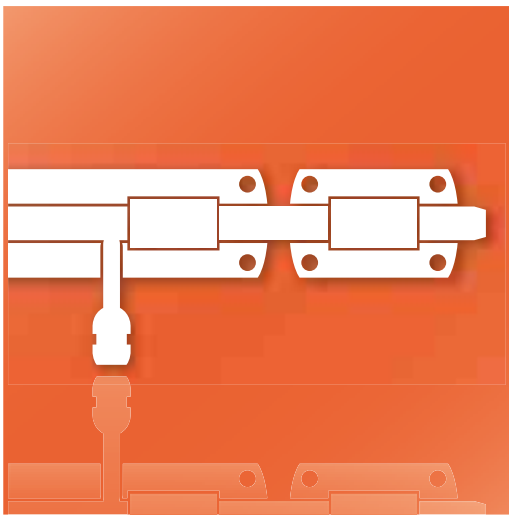

	A (mm)	B (mm)	FINITURA FINISH	
553.3050.0	30	50	GREZZO / RAW	50
553.4060.0	40	60	GREZZO / RAW	50
553.4080.0	40	80	GREZZO / RAW	50
553.50100.0	50	100	GREZZO / RAW	50
553.3050.1	30	50	ZINCATO BIANCO WHITE GALVANIZED STEEL	50
553.4060.1	40	60	ZINCATO BIANCO WHITE GALVANIZED STEEL	50
553.4080.1	48	80	ZINCATO BIANCO WHITE GALVANIZED STEEL	50
553.50100.1	50	100	ZINCATO BIANCO WHITE GALVANIZED STEEL	50



CATENACCI BOLTS

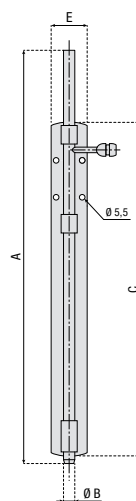

Catenacci verticali con piolino
Vertical bolts with pip



	A (mm)	Ø B (mm)	C (mm)	E (mm)	
701.1	230	16	140	50 x 3	8
701.2	560	16	465	50 x 3	6
701.3	740	20	630	50 x 4	2

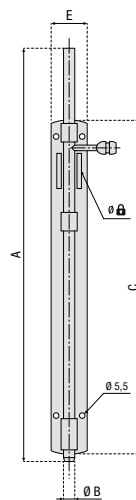

Catenacci verticali con portacucchetto
Vertical bolts with padlock holder

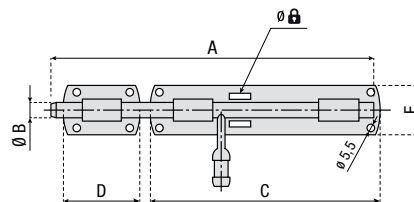

	A (mm)	Ø B (mm)	C (mm)	E (mm)	Ø 	
702.1	420	12	385	35 x 3	12	6
702.2	420	16	385	35 x 3	12	6
702.3	560	16	465	50 x 3	12	6
702.4	560	20	465	50 x 4	12	4

Catenacci orizzontali con fori di fissaggio
Horizontal bolts with fixing holes



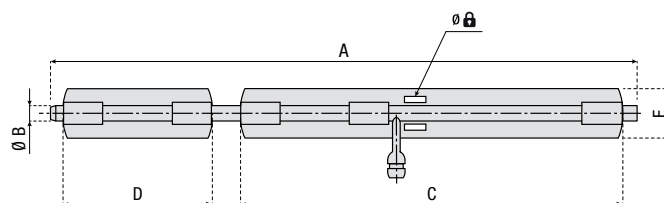

	A (mm)	Ø B (mm)	C (mm)	D (mm)	E (mm)	Ø 8.5	
703.1	100	10	68	15	35 x 3	8,5	20
703.2	150	12	100	40	35 x 3	8,5	12
703.3	200	12	155	55	35 x 3	8,5	10
703.4	250	12	180	55	35 x 3	8,5	10
703.5	245	16	180	70	35 x 3	8,5	8
703.6	320	16	245	75	50 x 3	8,5	8

Catenacci orizzontali in acciaio inox con port lucchetto e fori di fissaggio
Stainless steel horizontal bolts with padlock holder and fixing holes



- applicabili in versione Dx o Sx
- right or left versions

	A (mm)	Ø B (mm)	C (mm)	D (mm)	E (mm)	Ø 8.5	
707.1	150	12	100	25	35 x 3	8,5	6
707.2	200	12	155	55	35 x 3	8,5	6
707.3	215	16	140	42	50 x 3	8,5	4
707.4	245	16	180	70	50 x 3	8,5	4
707.5	320	16	245	75	50 x 3	8,5	2

Catenaccio a ginocchiera
Toggle bolt

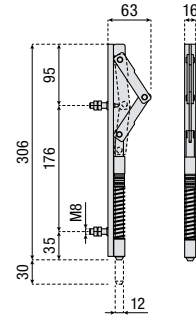

710.0



12

Paletto automatico per cancelli a 2 ante
Automatic spring bolt for 2 wings gates

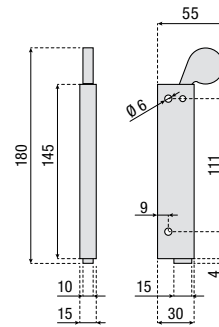

711.0



6

Catenaccio a gomito inox
Automatic stainless steel bolt

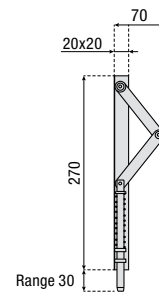

2700.0



8

Anticaduta per anta
Safety cable for swing gate

new

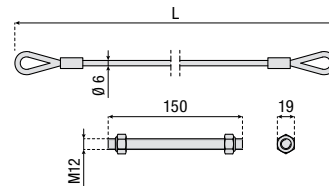

	L (mm)	d (mm)	PORTATA CAPACITY	FINITURA FINISH
750.401	400	6	800 kg	ZINCATO BIANCO WHITE GALVANIZED
750.501	500	6	800 kg	---
750.601	600	6	800 kg	---

- Disponibile anche in versione INOX
- Stainless steel version available



BENINCÀ · HOLDING

BENINCÀ HOLDING SpA

via Capitello, 43

36066 Sandrigo (VI) ITALY

T +39 0444 751030

F +39 0444 759728

www.benincaholding.com

US branch :

BENJOY AMERICA LLC. dba



6357 NW 99 AVE

Miami FL 33178

ph. + 1 - 305 - 418 0090

fax + 1 - 305 - 716 9271

beninca.usa@beninca.com

www.beninca-usa.com

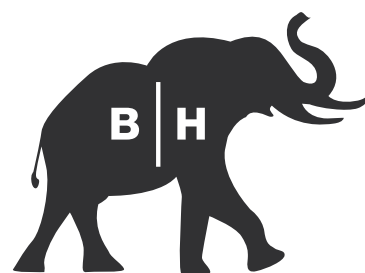

BENINCÀ HOLDING oggi è diventata una splendida realtà, un sogno che si è concretizzato per dare forma ad obiettivi di specializzazione da sempre perseguiti.

Una scelta istituzionale per esprimere una mission precisa: offrire soluzioni operando da specialisti nel settore automazione.

L'elefante è il testimone formale che abbiamo scelto per **BENINCÀ HOLDING**, il simbolo che meglio rappresenta la scelta precisa di solidità, affidabilità istituzionale, ma anche intelligenza e dinamismo verso i partners internazionali e verso tutti i clienti.

Today **BENINCÀ HOLDING** has become a splendid reality, a dream that has come true to give shape to aims of specialisation that we have always pursued.

A corporate decision to express a precise mission: offering solutions by acting as specialists in the automation sector.

The elephant is the symbol we have chosen for **BENINCÀ HOLDING**, the image that best represents our precise choice of corporate strength and reliability, but also intelligence and dynamism when interacting with international partners and with all customers.



AUTOMATISMI BENINCÀ SpA

via Capitello, 45

36066 Sandrigo (VI) ITALY

T +39 0444 751030

F +39 0444 759728

www.beninca.com

sales@beninca.it



AUTOMATISMI CAB Srl

via della Tecnica, 10 (Z.I.)

36010 Velo D'Astico (VI) ITALY

T +39 0445 741215

F +39 0445 742094

www.automatismicab.com

info@automatismicab.com



HI MOTIONS Srl

via dell'Industria, 91

36030 Sarcedo (VI) ITALY

T +39 0445 367536

F +39 0445 367520

www.himotions.com

info@himotions.com



RISE Srl

via Maso, 27

36035 Marano V. (VI) ITALY

T +39 0444 751401

www.riseweb.it

info@riseweb.it



BYOU

via Capitello, 45

36066 Sandrigo (VI) ITALY

T +39 0444 1510294

F +39 0444 759728

www.byouweb.com

info@byouweb.com



MYONE Srl

via T. Edison, 11

30035 Ballò di Mirano (VE) ITALY

T +39 041 412542

F +39 041 412542

www.myoneautomation.com

info@myoneautomation.com



HI-MOTIONS S.r.l.

Via dell'Industria, 91 // 36030 Sarcedo (VI) ITALY
T +39 0445 367536 // **F** +39 0445 367520
info@himotions.com // www.himotions.com