



**THE FIRST NAME IN CAMPING.
THE TRUSTED NAME IN RVs.**

1705RB Light LX Series

Weights:

Average Shipping Weight 3586 LBS

Dry Hitch Weight: 505 lbs

Cargo Capacity: 1254 lbs

Measurements:

Height: 10' 5"

Length: 21' 11"

Width: 8'

Capacities:

Fresh Water: 46 gal

Black Water: 39 gal

Grey Water: 39 gal

Sleeps 3

Decor:

Ironwood

Floorplan:

Couples trailer with queen size murphy bed and rear bath.

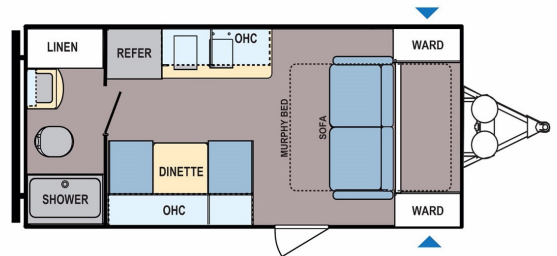

Features:

Aluminum Framed Walls, Crowned Galvanized Stamped Steel Rafters, Awning, Residential-grade Flooring, Interior and Exterior Speakers, Easy-lube Axles, Front Rock-guard Plate, Thermoformed Kitchen Countertops, Foot Pedal Flush Toilet, Dual 20lb Propane Bottles, Spare Tire, 6cu ft Refrigerator, Stereo AM/FM/MP3/SC/Aux, Tinted Safety-glass Windows, LED Strip Under Awning, Solid State Converter w/Built-in Battery Charger, Glass Top Range, Interior Power Command Centre and much more!



251 Cockshutt Rd, Brantford N3T 0N3